

Section No. 17

Congressional Township No. 27 . R. 14

Scale—Forty rods to an inch, or ten rods to a space. Congress Land, which is one mile square for a section.

Number of acres in this section, according to the United States Survey, _____

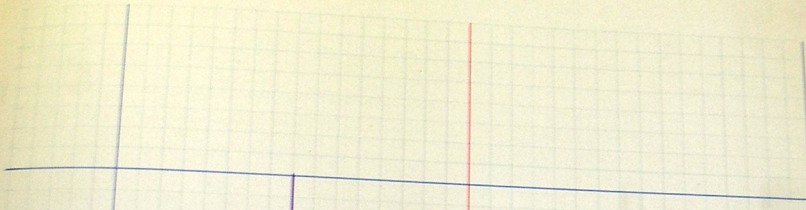

Congressional Township No. 27, R. 14

Scale—Forty rods to an inch, or ten rods to a space. Congress Land, which is one mile square for a section.
 Number of acres in this section, according to the United States Survey.

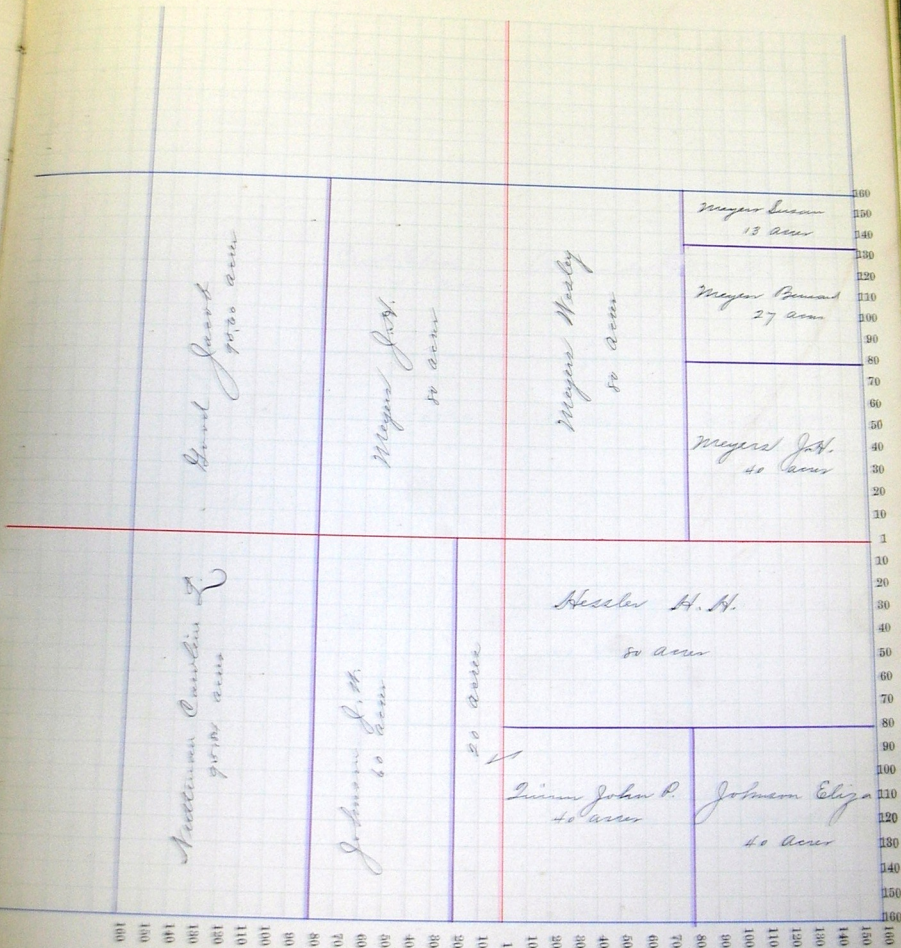

100
150
140
130
120
110
100
90
80
70
60
50
40
30
20
10
1
10
20
30
40
50
60
70
80
90
100
110
120
130
140
150
160

Section No. 17

Congressional Township No. 27, R. 14

Scale—Forty rods to an inch, or ten rods to a space. Congress Land, which is one mile square for a section.
 Number of acres in this section, according to the United States Survey.

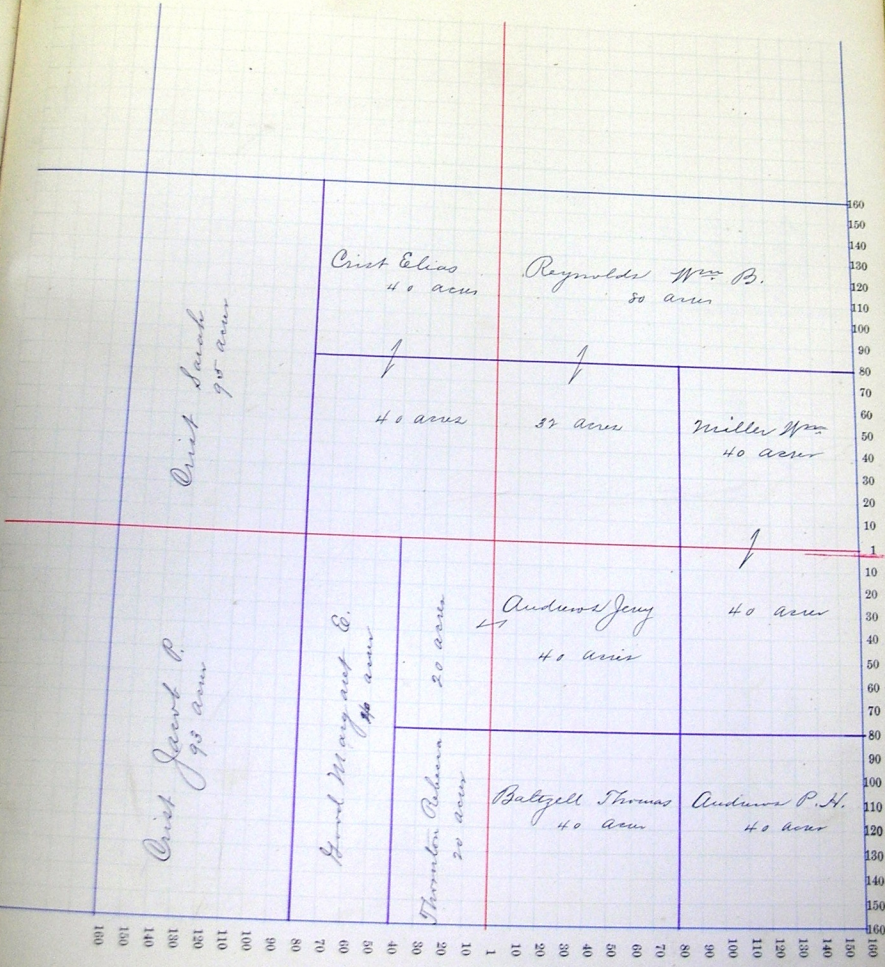

Congressional Township No. 27, R. 14

Scale—Forty rods to an inch, or ten rods to a space. Congress Land, which is one mile square for a section.
 Number of acres in this section, according to the United States Survey.

