

County, Indiana, 1880.

Assessor's Plat-Book for

Township, No. 1

NAMES OF OWNERS.	Number of Plat	DESCRIPTION.	Section	Township	Range	Mileage	Value	
							Land	Improvements
Maloy Thomas	1	1/2 A. 1/2	16	5	20	0	50	20
do	2	1/2	16	5	20	0	50	20
do	3	1/2	16	5	21	0	50	20
do	4	1/2	16	5	22	0	50	20
do	5	1/2	16	5	23	0	50	20
do	6	1/2	16	5	24	0	50	20
do	7	1/2	16	5	25	0	50	20
Maloy John	8	1/2	16	5	26	0	50	20
do	9	1/2	16	5	27	0	50	20
L. S. Thomas	10	1/2	16	5	28	0	50	20
do	11	1/2	16	5	29	0	50	20
Olson Joseph	12	1/2	16	5	30	0	50	20
Muller Joseph	13	1/2	16	5	31	0	50	20
Reed John	14	1/2	16	5	32	0	50	20
Erwin Saml	15	1/2	16	5	33	0	50	20
Reed W.	16	1/2	16	5	34	0	50	20

Section No. 3

Congressional Township No. 28, N., R. 16 E.

SCALE:—Forty rods to an inch, or ten rods to a space. Congress Land, which is one mile square for a section.

Number of acres in this section according to the UNITED STATES Survey — 652 ²²/₁₀₀

for Section No. 3, 80 acres

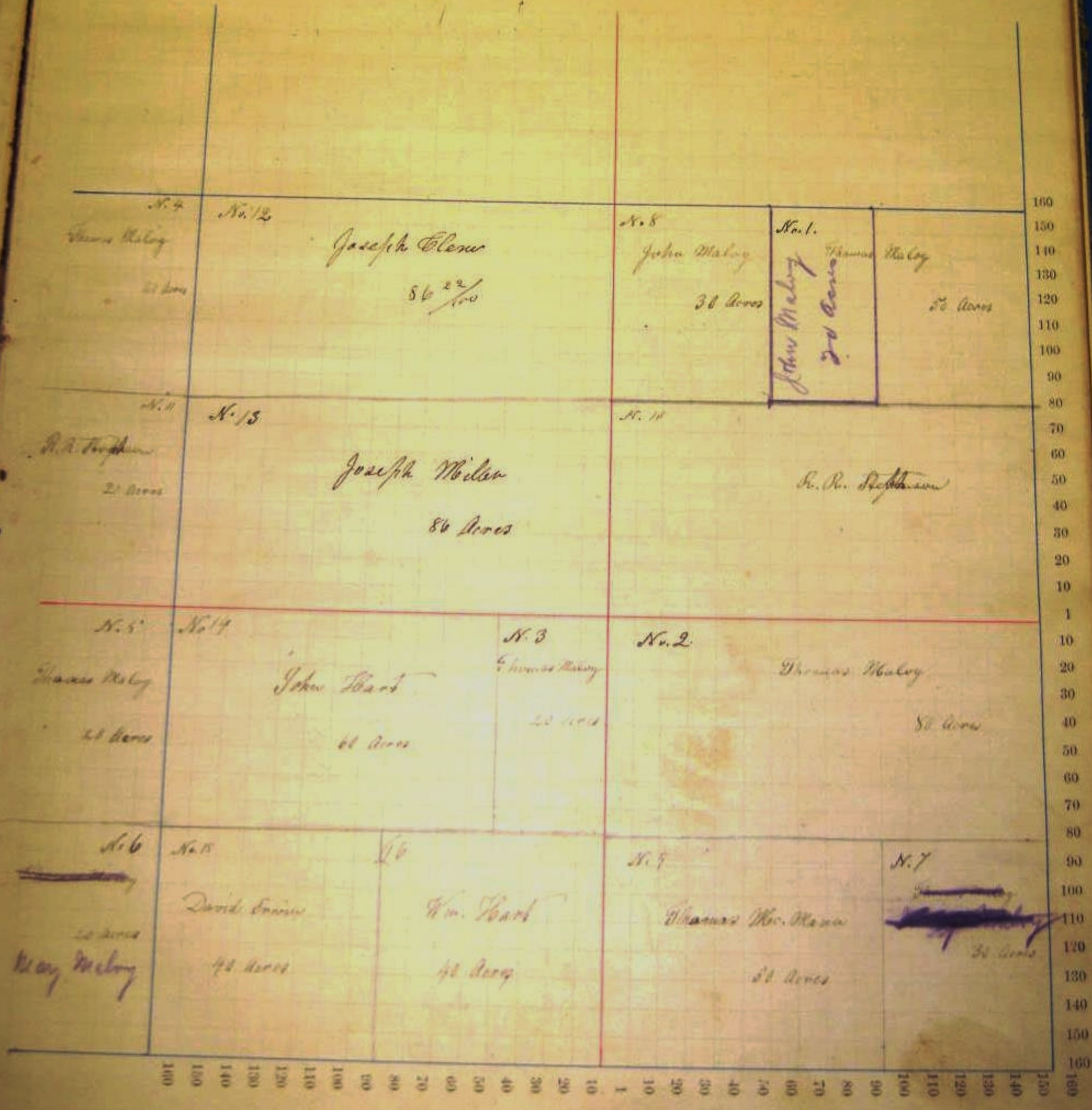

Adams

County, Indiana, 1880.

Assessor's Plat-Book for

Union

Township, No. 1

NAMES OF OWNERS.	Number on Plat.	DESCRIPTION.	Acres.	Hundredths.	Value of Lands.	Value of Improvements.	Value of Lands and Improvements.
Bentley John	1	SE	80	25	175	200	375
Glenn John	2	NE	80	25	615	215	830
Ray Henry	3	SE	80	25	740	50	790
Henry John	4	SE	87	25	610	180	790
Henry George	5	NE	80	25	480	15	495
Henry Adam	6	NE	87	25	605	76	685
Bentley John	7	SE	80	25	440	110	550
Crain David	8	SE	70	25	220	80	300
Clark Edward	9	NE	80	25	210		210

Section No. 4

Congressional Township No. 25, N., R. 16 E.

SCALE:—Forty rods to an inch, or ten rods to a space, Congress Land, which is one mile square for a section.

Number of acres in this section according to the UNITED STATES Survey 649

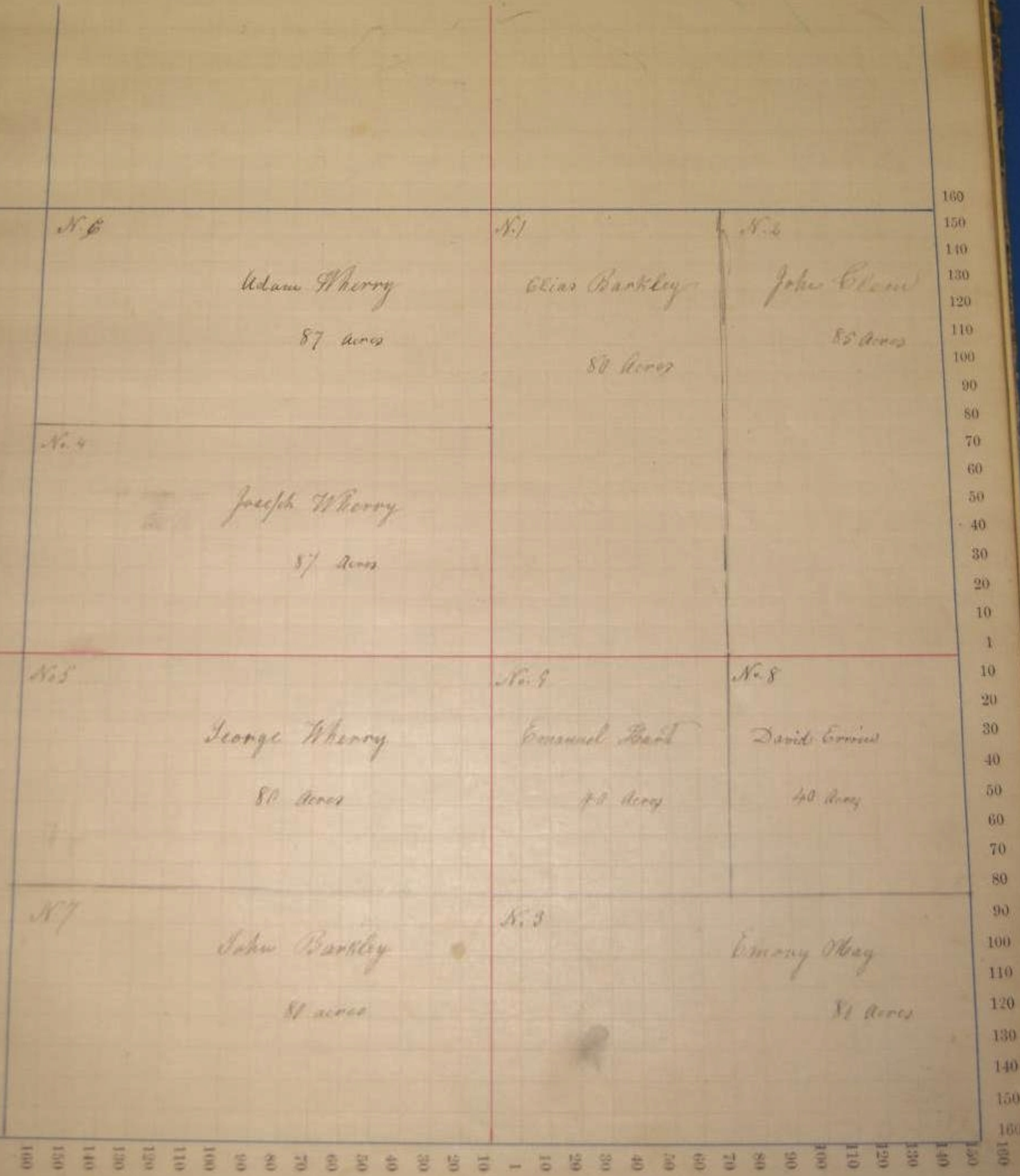

Assessor's Plat-Book for Union Township, No. 1

NAMES OF OWNERS.	Number on Plat.	DESCRIPTION.		Section	Township	Range	Acres.	Hundredths	Value of Land.	Value of Improvements.	Value of Land and Improvements.
Wherry Joseph	1	N 3	S 6	9	25	15	80		480	80	560
W. J. B. Wass	2	S 1/2	N 6	5	-	-	85		595	220	815
Wass Samuel heirs	3	N 1/2	N 6	5	-	-	90		675	130	805
Gleibler David	4	S 6	S 6	5	-	-	81		200		200
Loren W. d.	5	N 1/2	S W 1/4	5	-	-	81		550	100	650
Loren Martha	6	N 1/2 E 1/2	S W 1/4	5	-	-	40		295	40	335
Loug George	7	S W 1/4	S 6	5	-	-	40		240	20	260
Swartz Wm.	8	S 1/2	N W 1/4	5	-	-	80		560	140	700
Do	9	S 1/2	S W 1/4	5	-	-	40		240	15	255
W. C. Cardle James	10	N 1/2	N W 1/4	5	-	-	95		620		620

Section No. 1

Congressional Township No. 28, N., R. 15 E.

SCALE—Forty rods to an inch, or ten rods to a space, Congress Land, which is one mile square for a section.
 Number of acres in this section according to the UNITED STATES Survey—670

