

Assessor's Plat-Book for Preble Township, No. _____

Congressional Township No. 28, R. 19

| NAMES OF OWNERS | Number on Plat | DESCRIPTION | Section | Township | Range | Acres | Hundredths | Value of Lands | Value of Improvements | Value of Lands and Improvements |
|-------------------|----------------|--------------|---------|----------|-------|-------|------------|----------------|-----------------------|---------------------------------|
| Bultheimer Wm. | 1 | pt n 1/2 ne | 9 | 28 | 19 | 64 | | 2151 | 590 | |
| " " | " | pt n 1/2 ne | " | " | " | 71 | | 370 | | |
| Buuck Lewis | 2 | s 1/4 ne | " | " | " | 85 | | 2900 | 630 | |
| Reese Herman | 3 | pt n 1/2 wt | " | " | " | 75 | | 2050 | 590 | |
| Gallmeyer Sophia | 4 | sw | " | " | " | 40 | | 1100 | 420 | |
| Hoffman Daniel W. | 5 | se | " | " | " | 40 | | 980 | 350 | |
| " " | " | spt se wt | " | " | " | 5 | | 120 | | |
| Reifstak Ludwig | 6 | w 1/2 sw | " | " | " | 80 | | 2720 | 600 | |
| Scheumann Ernst | 7 | spt e 1/2 sw | " | " | " | 19 | 40 | 440 | 130 | |
| " " | " | spt e 1/2 sw | " | " | " | 19 | | 480 | | |
| Conrad Christ | 8 | pt e 1/2 sw | " | " | " | 13 | 64 | 400 | | |
| " " | " | pt e 1/2 sw | " | " | " | 16 | 04 | 490 | | |
| Buuck Otto | 9 | pt e 1/2 sw | " | " | " | 14 | | 430 | | |
| Decker Fred | 10 | n 1/2 se | " | " | " | 80 | | 2730 | 630 | |
| Conrad August | 11 | s 1/2 se | " | " | " | 80 | | 2560 | 750 | |

SCALE: Forty rods to an inch, or ten rods to a space, Congress Land, which is one mile square for a section.
Number of acres in this section, according to the United States Survey, _____

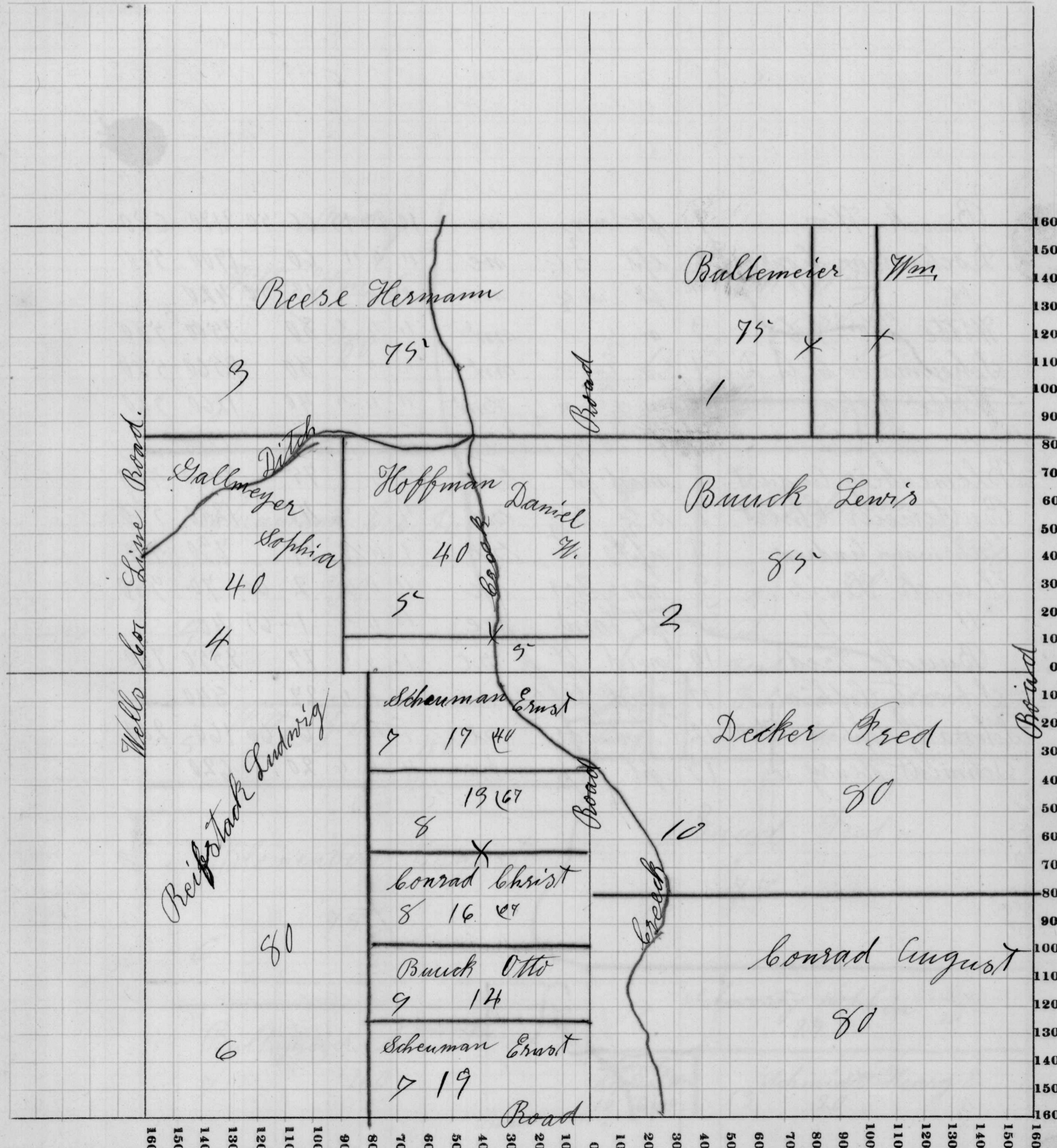

Assessor's Plat-Book for Preble Township, No. _____

Congressional Township No. 28, R. 13

| NAMES OF OWNERS | Number on Plat | DESCRIPTION | Section | Township | Range | Acres | Hundredths | Value of Lands | Value of Improvements | Value of Lands and Improvements |
|-----------------------|----------------|-----------------|---------|----------|-------|-------|------------|----------------|-----------------------|---------------------------------|
| Bauck Wm | 1 | pt n 1/2 ne | 10 | 28 | 13 | 66 | 50 | 2180 | 650 | |
| Doehrmann Conrad | 2 | ept 3 1/2 ne | " | " | " | 60 | | 1900 | 500 | |
| " " | " | pt n 1/2 ne | " | " | " | 13 | 50 | 420 | | |
| Witte Wm. G. | 3 | n 1/2 wd | " | " | " | 80 | | 2500 | 580 | |
| Scheumann C. C. D. | 4 | s 1/2 wd | " | " | " | 80 | | 2560 | 580 | |
| Witte John | 5 | n 1/2 n 1/2 sw | " | " | " | 40 | | 1260 | 320 | |
| " " | " | pt n 1/2 sw | " | " | " | 5 | | 150 | | |
| Blomenberg August | 6 | mid pt sw | " | " | " | 75 | | 2460 | 420 | |
| Bullemeyer Christ | 7 | s 1/2 s 1/2 sw | " | " | " | 40 | | 1240 | 590 | |
| Fuhrmann Andrew | 8 | apt se | " | " | " | 24 | | 730 | 400 | |
| Bauck Lewis | 9 | nw cor se | " | " | " | 2 | 60 | 70 | 350 | |
| " " | " | pt nw se | " | " | " | 1 | 69 | 40 | | |
| Bauck Fred | 10 | mid pt se | " | " | " | 77 | | 2550 | 700 | |
| Schwartz Sophia | 11 | mid pt s 1/2 se | " | " | " | 27 | | 840 | | |
| Schwartz Sophia & Wm. | 12 | sw cor se | " | " | " | 6 | 66 | 160 | 200 | |
| Schmidt Henry E. | 13 | pt s 1/2 se | " | " | " | 20 | | 620 | | |

SCALE: Forty rods to an inch, or ten rods to a space, Congress Land, which is one mile square for a section.
Number of acres in this section, according to the United States Survey, _____

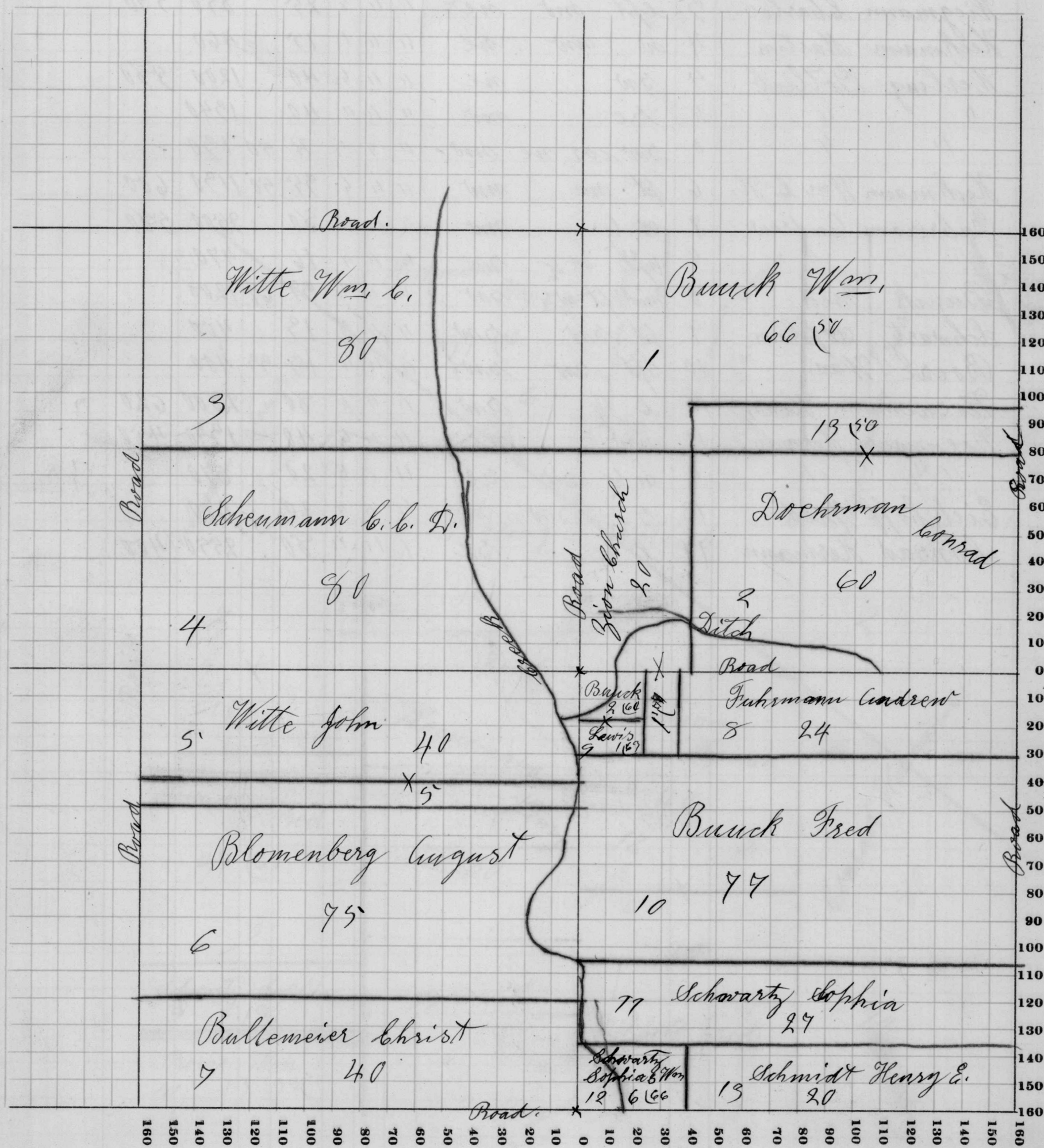

Assessor's Plat-Book for Preble Township, No.

Congressional Township No. 28, R. 13

SCALE: Forty rods to an inch, or ten rods to a space, Congress Land, which is one mile square for a section.

Number of acres in this section, according to the United States Survey,

| NAMES OF OWNERS | Number on Plat | DESCRIPTION | Section | Township | Range | Acres | Hundredths | Value of Lands | Value of Improvements | Value of Lands and Improvements |
|--------------------|----------------|-----------------|---------|----------|-------|-------|------------|----------------|-----------------------|---------------------------------|
| Scheumann Henry | 1 | pt ne 1/2 ne | 11 | 28 | 13 | 1 | 45 | 30 | | |
| Doehrmann Ernst | 2 | e 1/2 ne | " | " | " | 74 | | 2960 | 560 | |
| Wiegmann Charles | 3 | e pt sw ne | " | " | " | 25 | | 850 | 590 | |
| Hackmann Martin | 4 | w sw ne | " | " | " | 15 | | 460 | | |
| Werling Gottlieb | 5 | sw ne | " | " | " | 40 | | 1200 | 580 | |
| " " | " | se sw | " | " | " | 40 | | 1340 | | |
| " " | " | sw cor ne sw | " | " | " | 4 | 50 | 130 | | |
| Hackmann Wm. S. H. | 6 | pt ne sw | " | " | " | 35 | 50 | 1130 | 600 | |
| Fuhrmann Andrew | 7 | w 1/2 sw | " | " | " | 80 | | 2500 | 580 | |
| " " | " | n pt w 1/2 sw | " | " | " | 16 | | 470 | | |
| Buuck Fred | 8 | mid pt w 1/2 sw | " | " | " | 37 | 67 | 1200 | | |
| Schwartz Sophia | 9 | pt sw sw | " | " | " | 13 | | 400 | | |
| Boese Wm. | 10 | n pt sw sw | " | " | " | 13 | 39 | 400 | | |
| Koenemann Henry | 11 | e 1/2 sw | " | " | " | 80 | | 2800 | 620 | |
| Koenemann Herman | 12 | sw se | " | " | " | 40 | | 1340 | 450 | |
| " " | " | w 1/2 sw se | " | " | " | 20 | | 670 | | |
| Eickhoff Fred | 13 | s 1/2 sw se | " | " | " | 20 | | 670 | | |
| Conrad Hermann | 14 | e 1/2 se | " | " | " | 80 | | 2550 | 400 | |

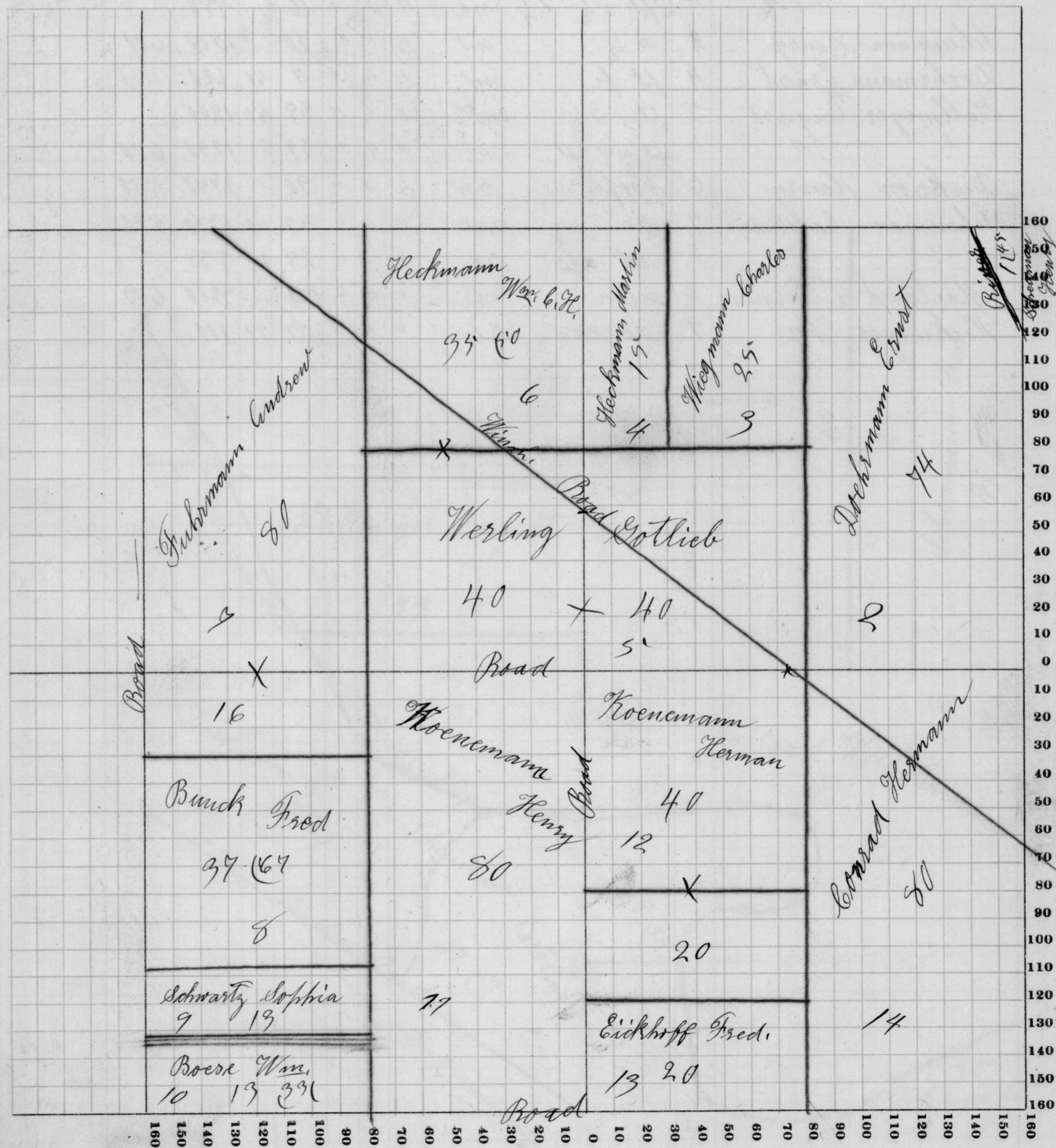

Assessor's Plat-Book for Preble Township, No.

Congressional Township No. 28, R. 13

| NAMES OF OWNERS | Number on Plat | DESCRIPTION | Section | Township | Range | Acres | Hundredths | Value of Lands | Value of Improvements | Value of Lands and Improvements |
|--------------------|----------------|------------------|---------|----------|-------|-------|------------|----------------|-----------------------|---------------------------------|
| Scheumann Fred H. | 1 | el/2 el/2 ne | 12 | 28 | 13 | 40 | | 1950 | 750 | |
| " " | 1 | pt ne el/2 ne | " | " | " | 24 | | 530 | | |
| Gallmeyer Henry G. | 2 | w 1/2 ne | " | " | " | 80 | | 2840 | 540 | |
| " " | " | pt w 1/2 el/2 ne | " | " | " | 16 | | 550 | | |
| Scheumann Henry | 3 | w 1/2 nw | " | " | " | 80 | | 2500 | 600 | |
| Doehrmann Ernst | 4 | pt fr nw | " | " | " | 4 | 50 | 120 | | |
| Gallmeyer August | 5 | pt s 1/2 nw | " | " | " | 39 | 50 | 1240 | | |
| " " | " | pt nw pt sw | " | " | " | 39 | | 1240 | 600 | |
| Dirkson Henry | 6 | sw pr sw | " | " | " | 90 | | 2750 | 550 | |
| Scheumann Caroline | 7 | se sw | " | " | " | 47 | 50 | 1380 | 540 | |
| " " | " | sw fr se | " | " | " | 25 | 24 | 780 | | |
| Mailand Wilhelmina | 8 | ne fr se | " | " | " | 101 | | 3200 | 600 | |
| Rockmeyer Wm | 9 | se cor se | " | " | " | 3 | 75 | 100 | | |

SCALE: Forty rods to an inch, or ten rods to a space, Congress Land, which is one mile square for a section.
 Number of acres in this section, according to the United States Survey,.....

