

Assessor's Plat-Book for Preble Township, No.

Congressional Township No. 28, R. 13

NAMES OF OWNERS	Number on Plat	DESCRIPTION	Section	Township	Range	Acres	Hundredths	Value of Lands	Value of Improvements	Value of Lands and Improvements
Bieberich Wm. J.	1	e 1/2 ne	25	28	13	80		2820	630	
Koenemann Otto	2	w 1/2 ne	"	"	"	80		2870		
Koenemann Fred	3	npt	"	"	"	72		2420	580	
Koenemann Gustav	4	spt	"	"	"	88		3060	630	
Peck Otto	5	n 1/2 sw	"	"	"	80		2800	700	
Meyer Wm. M.	6	s 1/2 sw	"	"	"	80		2850	700	
Bieberich Daniel	7	w 1/2 se	"	"	"	80		2870	600	
Selking August	8	e 1/2 se	"	"	"	80		2820	580	

SCALE: Forty rods to an inch, or ten rods to a space, Congress Land, which is one mile square for a section.
 Number of acres in this section, according to the United States Survey,.....

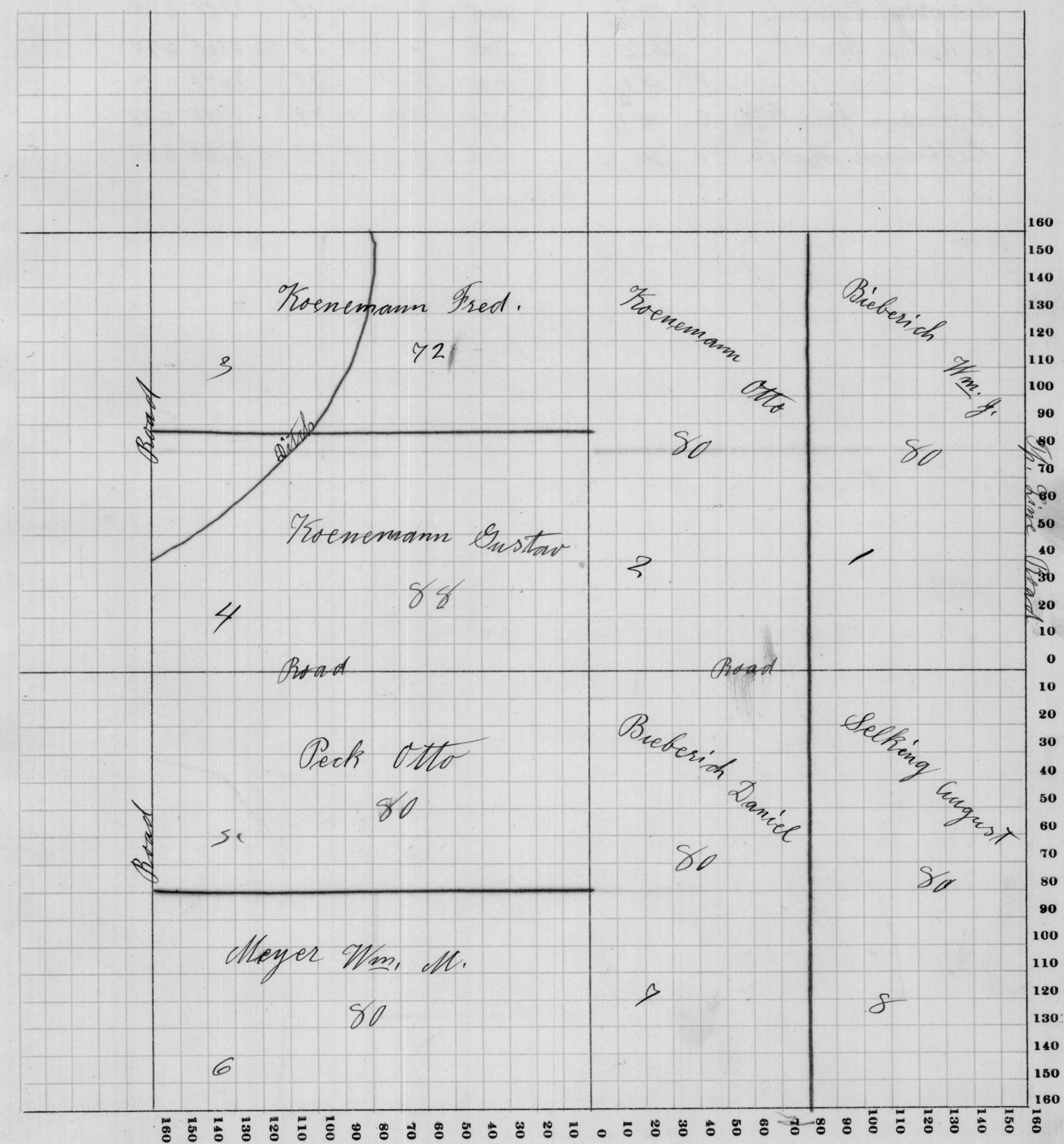

Adams

Assessor's Plat-Book for

Preble

Township, No.

Congressional Township No. 28, R. 13

NAMES OF OWNERS	Number on Plat	DESCRIPTION	Section	Township	Range	Acres	Hundredths	Value of Lands	Value of Improvements	Value of Lands and Improvements
Ehlerding Wm.	1	w 1/2 me	26	28	13	80		2850	400	
Schuler Fred	2	s 1/2 ne	"	"	"	80		2780	650	
Ehlerding Christ	3	w 1/2 nw	"	"	"	80		2740	650	
Scherry Emilie	4	s 1/2 nw	"	"	"	80		2700	650	
Schuler Jacob	5	e 1/2 sw	"	"	"	79	52	2560	650	
" "	6	w 1/2 sw	"	"	"	80		2690		
Hoffmann John G. H.	6	w 1/2 se	"	"	"	79		2720	680	
Hoffmann Maria	7	e 1/2 se	"	"	"	79	50	2760	650	

SCALE: Forty rods to an inch, or ten rods to a space, Congress Land, which is one mile square for a section.

Number of acres in this section, according to the United States Survey,

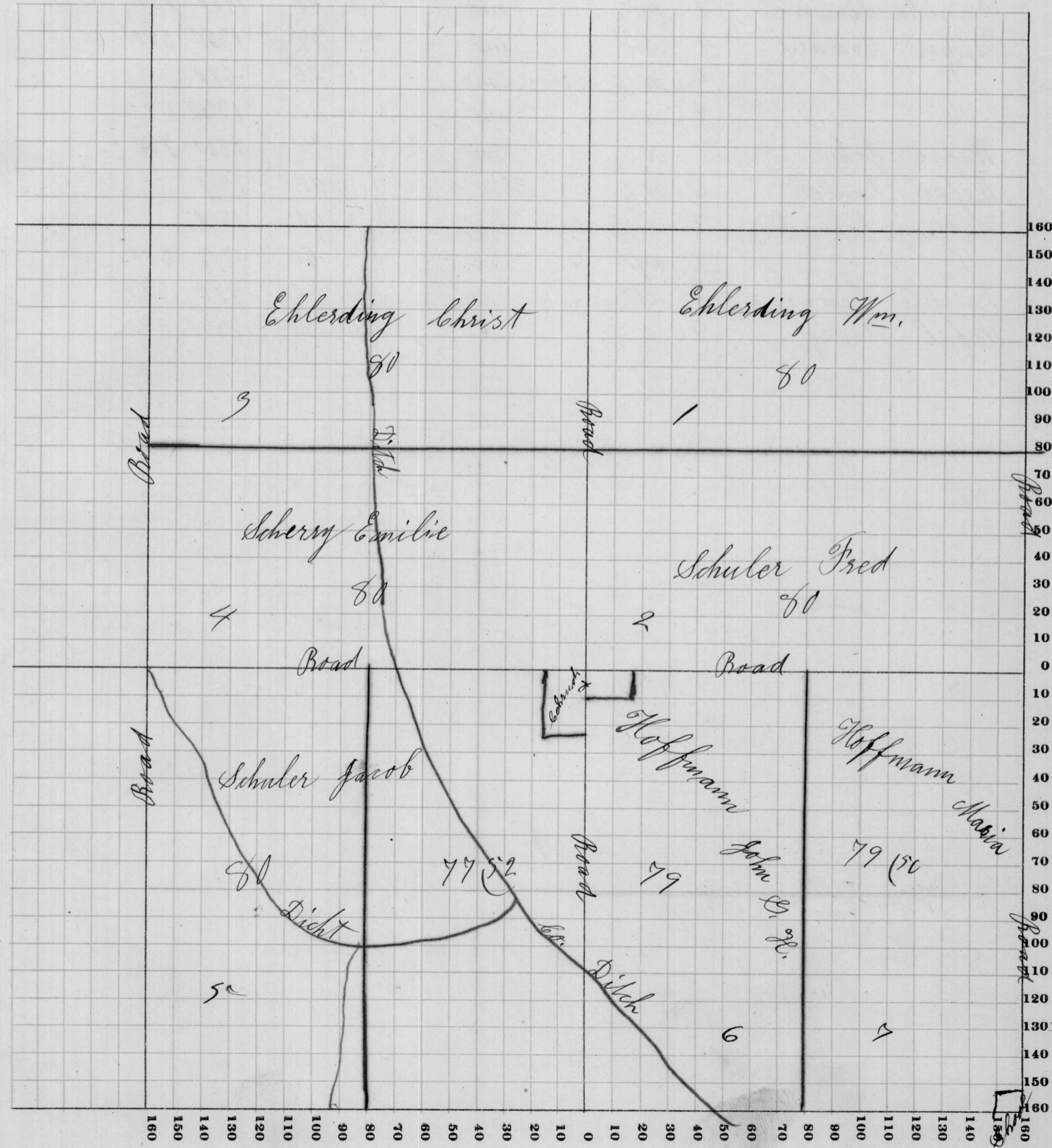

Adams

COUNTY, INDIANA, 1915

SECTION No. 27

Congressional Township No. 28, R. 13

Assessor's Plat-Book for

Preble

Township, No.

SCALE: Forty rods to an inch, or ten rods to a space, Congress Land, which is one mile square for a section.

Number of acres in this section, according to the United States Survey,

NAMES OF OWNERS	Number on Plat	DESCRIPTION	Section	Township	Range	Acres	Hundredths	Value of Lands	Value of Improvements	Value of Lands and Improvements
Kilgemann Emma	1	w 1/2 ne	27	28	13	80		2800		
Peck Fred.	2	s 1/2 ne	"	"	"	80		2660	680	
" "	"	e 1/2 se	"	"	"	20		680		
Reinike Simon W.	3	sw	"	"	"	40		1400	780	
Reppert Oswald	4	sw	"	"	"	39		1350	650	
" " "	"	w 1/2 se	"	"	"	20		670		
" " "	"	ne	"	"	"	40		1380		
Wefel John	5	w 1/2 sw	"	"	"	80		2800	750	
Wefel Daniel	6	w 1/2 e 1/2 sw	"	"	"	40		1400		
Werling John D.	7	e 1/2 e 1/2 sw	"	"	"	40		1400		
" " "	"	w 1/2 se	"	"	"	50		1700	680	
Bruchte Lewis	8	e 1/2 w 1/2 se	"	"	"	30		980	520	
Wefel Henry	9	s 1/2 se	"	"	"	80		2850	650	

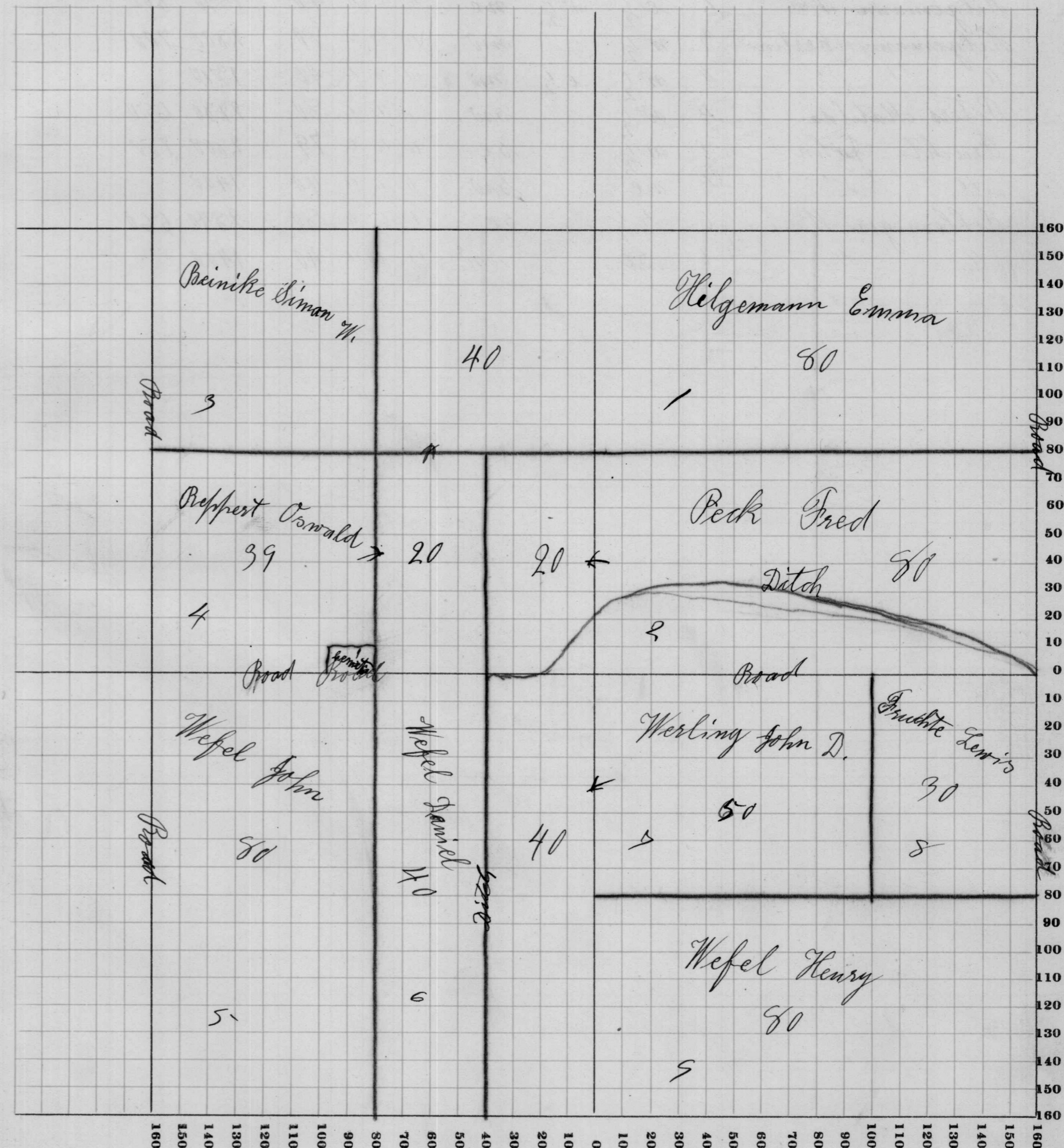

Assessor's Plat-Book for Preble Township, No.

Congressional Township No. 28, R. 13

NAMES OF OWNERS	Number on Plat	DESCRIPTION	Section	Township	Range	Acres	Hundredths	Value of Lands	Value of Improvements	Value of Lands and Improvements
Hilgemann John	1	e 1/2 ne	28	28	13	79		2660		
" "	"	w 1/2 w 1/2 ne	"	"	"	40		1990		
" "	"	e 1/2 e 1/2 wt	"	"	"	40		1990		
Hilgemann Wan.	2	e 1/2 w 1/2 ne	"	"	"	40		1990	800	
Hilgemann Martin	3	w 1/2 wt	"	"	"	80		2800	700	
" " "	"	w 1/2 e 1/2 wt	"	"	"	40		1990		
Peters Matilda	4	w 1/2 sw	"	"	"	80		2780	650	
Fruchte John	5	w 1/2 se	"	"	"	79		2800	750	
" "	"	sw	"	"	"	40		1400		
Sellemeyer Wan.	6	s 1/2 se	"	"	"	80		2840	560	
" "	"	sw	"	"	"	40		1400		

SCALE: Forty rods to an inch, or ten rods to a space, Congress Land, which is one mile square for a section. Number of acres in this section, according to the United States Survey,.....

