

Adams

Assessor's Plat-Book for Preble Township, No.

Congressional Township No. 28, R. 13

NAMES OF OWNERS	Number on Plat	DESCRIPTION	Section	Township	Range	Acres	Hundredths	Value of Lands	Value of Improvements	Value of Lands and Improvements
Schoemann Caroline	1	pt sw ne	13	28	13	2		40		
Fuhrmann Henry G.	2	e 1/2 ne	"	"	"	79		2900	550	
" " "	"	e 1/2 sw ne	"	"	"	18		360		
Spangler Jacob E.	3	sw ne	"	"	"	40		1050	350	
" " "	"	pt se sw	"	"	"	13		340		
" " "	"	pt w 1/2 se	"	"	"	2		30		
Bieberich Charles	4	pt sw ne	"	"	"	19		510		
" " "	"	sw pt	"	"	"	106		3200	550	
Spangler Jacob	5	1/2 sw	"	"	"	40	39	1300		
Kruehmann Wm	6	sw 1/2 sw	"	"	"	79	69	2800	670	
" " "	"	w 1/2 e 1/2 sw	"	"	"	40		1390		
Schultz Adolph & Wm.	7	e 1/2 e 1/2 sw	"	"	"	40		1390	700	
" " "	"	pt w 1/2 se	"	"	"	78		2660		
Kiess Charles	8	sw cor e 1/2 se	"	"	"	1		30		
" " "	"	e 1/2 se	"	"	"	79		2630	600	

SCALE: Forty rods to an inch, or ten rods to a space, Congress Land, which is one mile square for a section.

Number of acres in this section, according to the United States Survey,.....

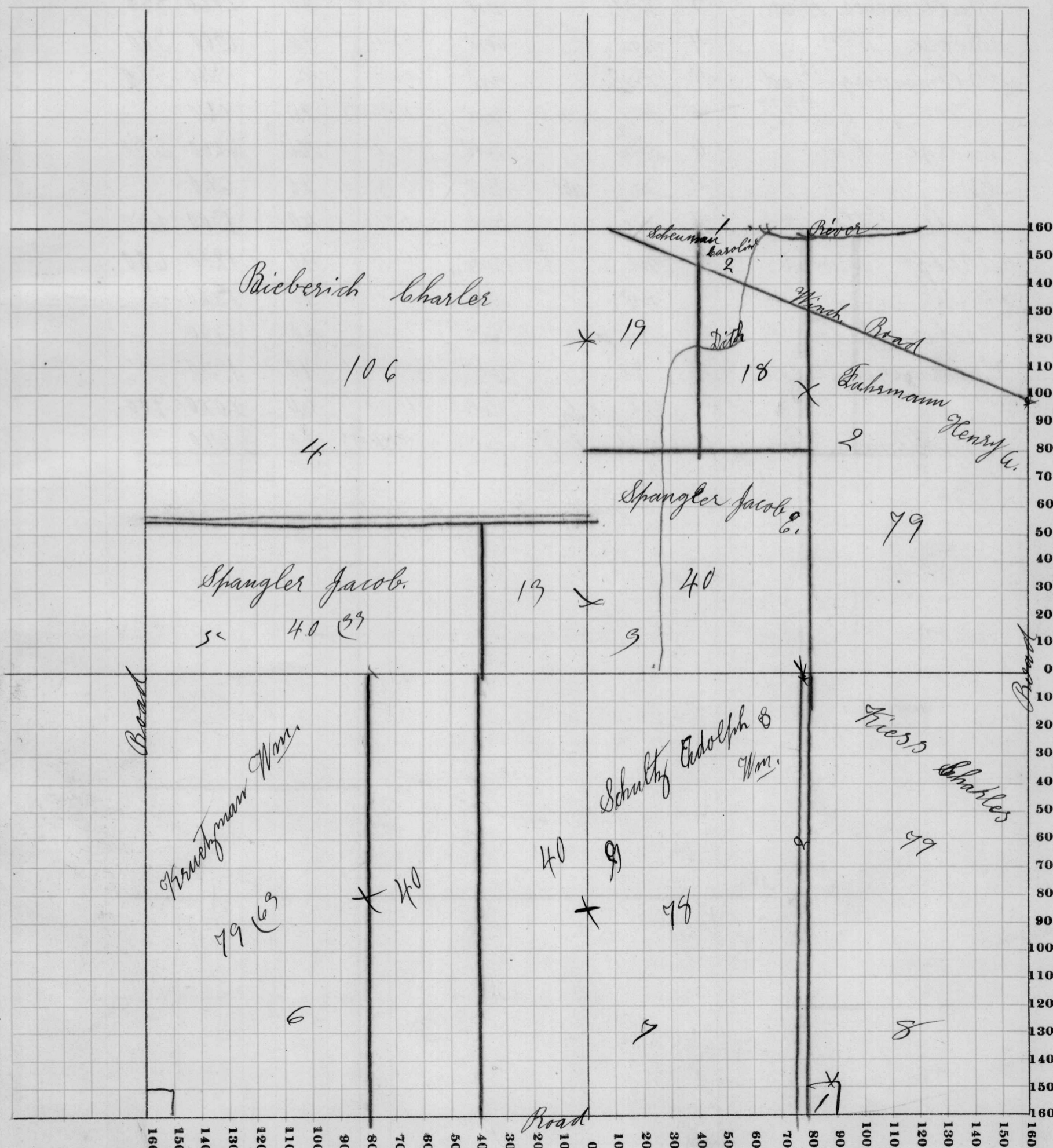

Adams

COUNTY, INDIANA, 1915

SECTION No. 14

Congressional Township No. 28, R. 13

Assessor's Plat-Book for Preble Township, No.

SCALE: Forty rods to an inch, or ten rods to a space, Congress Land, which is one mile square for a section.

Number of acres in this section, according to the United States Survey,

NAMES OF OWNERS	Number on Plat	DESCRIPTION	Section	Township	Range	Acres	Hundredths	Value of Lands	Value of Improvements	Value of Lands and Improvements
Doehrmann Conrad G.	1	pt ne ne	14	28	13	30		910	180	
Eickhoff Fred	2	sw 1/2 ne	"	"	"	80		2510	700	
" "	"	pt ne ne	"	"	"	10		340		
Buttemier Wm.	3	e 1/2 nw	"	"	"	80		2760	550	
Boese Wm.	4	nw nw	"	"	"	40		1900	300	
Blomenberg Fred	5	sw nw	"	"	"	40		1340	520	
" "	"	n 1/2 nw sw	"	"	"	20		660		
Muerge Carl	6	sw sw	"	"	"	40		1260	590	
" "	"	s 1/2 nw sw	"	"	"	20		620		
Ewell Otto	7	se sw	"	"	"	40		1300	650	
Eickhoff Christ	8	ne sw	"	"	"	40		1270	650	
" "	"	nw se	"	"	"	40		1360		
Kiefer Jacob M.	9	sw se	"	"	"	40		1330		
Ostermeyer Fred.	10	se ne	"	"	"	40		1380		
" "	"	pt e 1/2 se	"	"	"	60		2050	700	
Krutzmann Wm.	11	spt e 1/2 se	"	"	"	20		670		

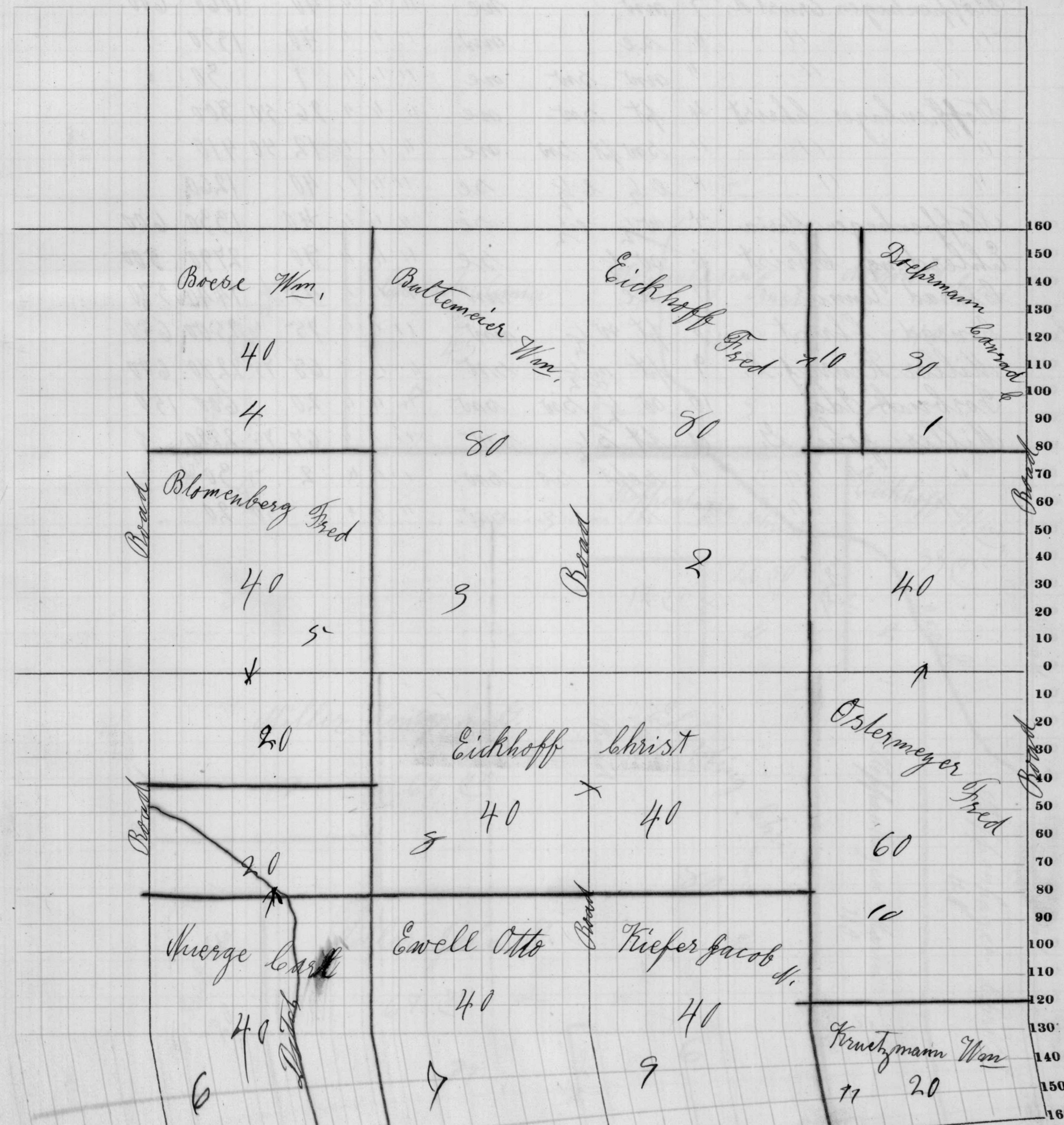

SCALE: Forty rods to an inch, or ten rods to a space, Congress Land, which is one mile square for a section. Number of acres in this section, according to the United States Survey,

NAMES OF OWNERS	Number on Plat	DESCRIPTION	Section	Township	Range	Acres	Hundredths	Value of Lands	Value of Improvements	Value of Lands and Improvements
Norwald Julia	1	ne ne	15	28	13	40		1280	290	
Eickhoff Wm	2	pt se ne	"	"	"	93	75	980	80	
" "	"	pt s 1/2 ne	"	"	"	6	25	180		
Stoppenhagen Ernst H.	3	nw ne	"	"	"	40		1060	600	
" "	"	se nw	"	"	"	40		1330		
" "	"	nw sw ne	"	"	"	1		30		
Stoppenhagen Christ	4	pt sw ne	"	"	"	26	50	800		
" "	"	sw pt sw ne	"	"	"	12	50	410		
" "	"	s 1/2 e 1/2 se	"	"	"	40		1260		
Stoppenhagen Maria	5	w 1/2 e 1/2 se	"	"	"	40		1330	600	
Ehlerding Christ	6	w 1/2 se	"	"	"	80		2490	500	
Conrad Anna	7	ne nw	"	"	"	45		1440	570	
Conrad Christ	8	pt w 1/2 nw	"	"	"	75		2500	650	
Miller Henry J. G.	9	pt n 1/2 sw	"	"	"	68	75	2280	600	
Forbrich Ida	10	w 1/2 sw sw	"	"	"	20		600	150	
Miller John G.	11	pt s 1/2 sw	"	"	"	67	75	2220		
" "	"	se pt se sw	"	"	"	2		30		
" "	"	s sw	"	"	"	50		20		



Assessor's Plat-Book for

Beeble

Township, No.

Congressional Township No. 28, R. 13

NAMES OF OWNERS	Number on Plat	DESCRIPTION	Section	Township	Range	Acres	Hundredths	Value of Lands	Value of Improvements	Value of Lands and Improvements
Conrad Anna	1	ne ne	16	28	13	35		1100		
Eickhoff Rudolph	2	wt me	16	"	"	40		1040	300	
" "	"	fit ne ne	"	"	"	5		140		
" "	"	fit ne wt	"	"	"	19	41	620		
Gallmeyer Henry F.	3	lpt s 1/2 me	"	"	"	60		2000	650	
" " "	4	wpit wt se	"	"	"	34		910		
" " "	"	lpt wt se	"	"	"	6		170		
Scheumann Ernst	4	lpt ne wt	"	"	"	11	06	330	250	
" "	"	wpit ne wt	"	"	"	9	53	270		
Scheumann August	5	se wt	"	"	"	40		1320	420	
" "	4	wt 1/2 sw ne	"	"	"	20		610		
Gallmeier Fred	6	wt 1/2 wt	"	"	"	80		2700	300	
" "	"	fit wt 1/2 sw	"	"	"	70		2290	350	
Ruppright G. W.	7	sw fit wt sw	"	"	"	50		1630	300	
Hartmann August	8	se sw	"	"	"	40		1080	300	
Bullemier Christ.	9	ne se	"	"	"	40		1330		
Kiefer Charles	10	s 1/2 se	"	"	"	80		2640	560	

SCALE: Forty rods to an inch, or ten rods to a space, Congress Land, which is one mile square for a section.  
 Number of acres in this section, according to the United States Survey, .....

