

NAMES OF OWNERS	Number on Plat	DESCRIPTION	Section	Township	Range	Acres	Hundredths	Value of Lands	Value of Improvements	Value of Lands and Improvements
Kleine Charles F.	1	npt ne	1	28	13	69		2070	580	
Wishmeyer Henry	2	sw	20	"	"	141	42	4630	700	
Cumman Wm.	3	apt ne	"	"	4	60		1890	600	
Kleine Lewis G.	4	se	"	"	4	157	72	4800	700	
Dirkson Henry	5	e 1/2 sw	"	"	"	80		2650	580	
Gallmeyer Henry	6	w 1/2 sw	"	"	"	80		2700		

SCALE: Forty rods to an inch, or ten rods to a space, Congress Land, which is one mile square for a section.

Number of acres in this section, according to the United States Survey,.....

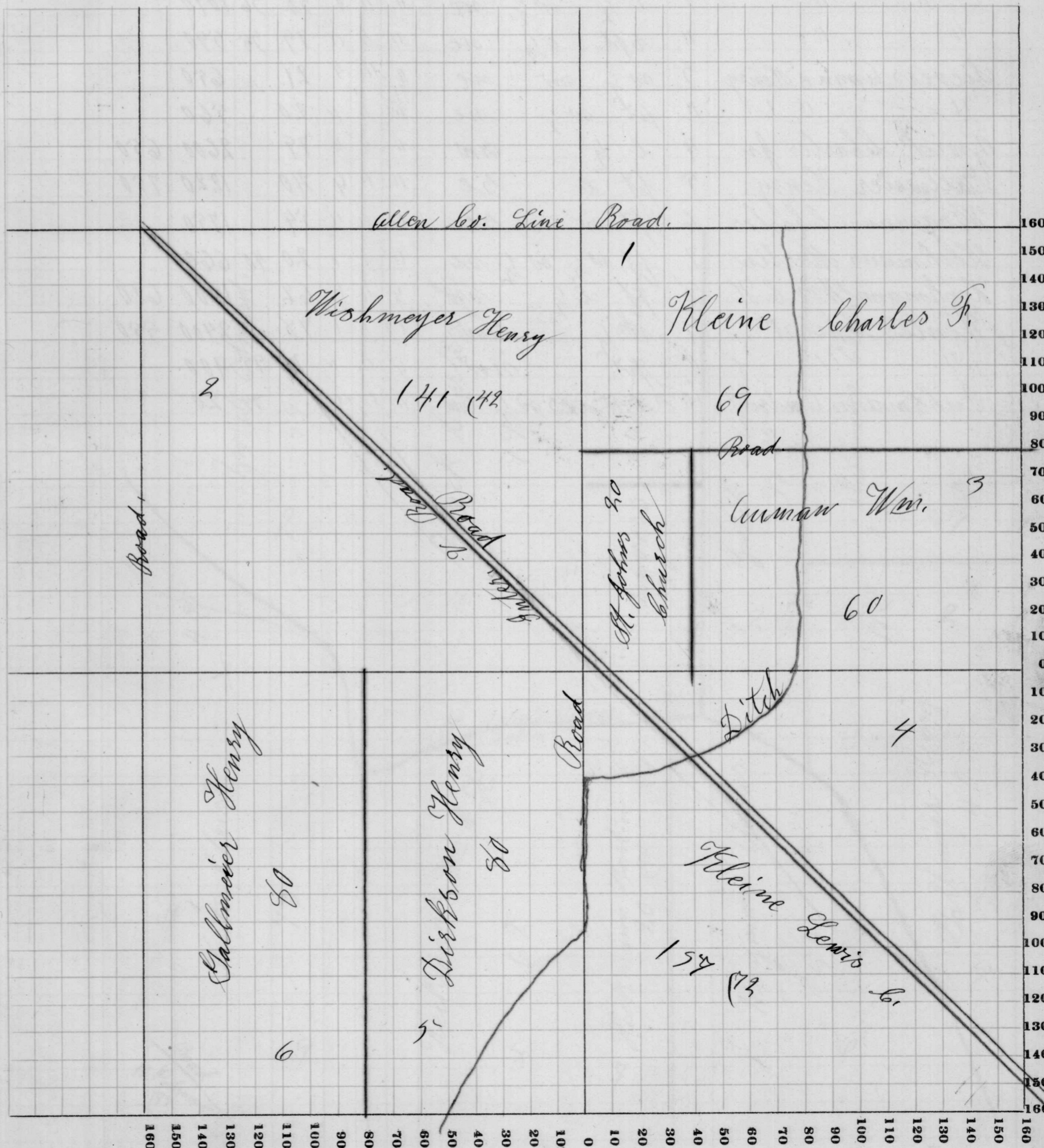

Assessor's Plat-Book for Preble Township, No. _____

Congressional Township No. 28, R. 13

NAMES OF OWNERS	Number on Plat	DESCRIPTION	Section	Township	Range	Acres	Hundredths	Value of Lands	Value of Improvements	Value of Lands and Improvements
Gallmeier Ernst	1	spt e 1/2 ne	2	28	13	52		1670		
Zwick Edward	2	spt nw	"	"	"	59	16	1900	550	
" "	"	e 1/2 w 1/2 ne	"	"	"	98	36	1010		
" "	"	spt e 1/2 ne	"	"	"	19	95	590		
Sievers Anna & Henry	9	w 1/2 nw ne	"	"	"	21		650		
" "	"	pt w 1/2 ne	"	"	"	20		560		
Zwick Charles Jr	4	e 1/2 nw	"	"	"	79		2600	650	
Gallmeier Henry	5	pt e se	"	"	"	40		1220	750	
Wiegmann Charles	6	pt w se	"	"	"	54		1750		
Heckmann Martin	7	pt w 1/2 w 1/2 se	"	"	"	20	40	660		
Heckmann Wm. C. Jr.	8	pt e 1/2 sw	"	"	"	62		1980	690	
Wente Christ	9	w 1/2 sw	"	"	"	78		2400	550	
" "	"	pt nw	"	"	"	4	95	100		
Fuhrmann Andrew	10	sw cor w 1/2 sw	"	"	"		75	20		

SCALE: Forty rods to an inch, or ten rods to a space, Congress Land, which is one mile square for a section.
Number of acres in this section, according to the United States Survey, _____

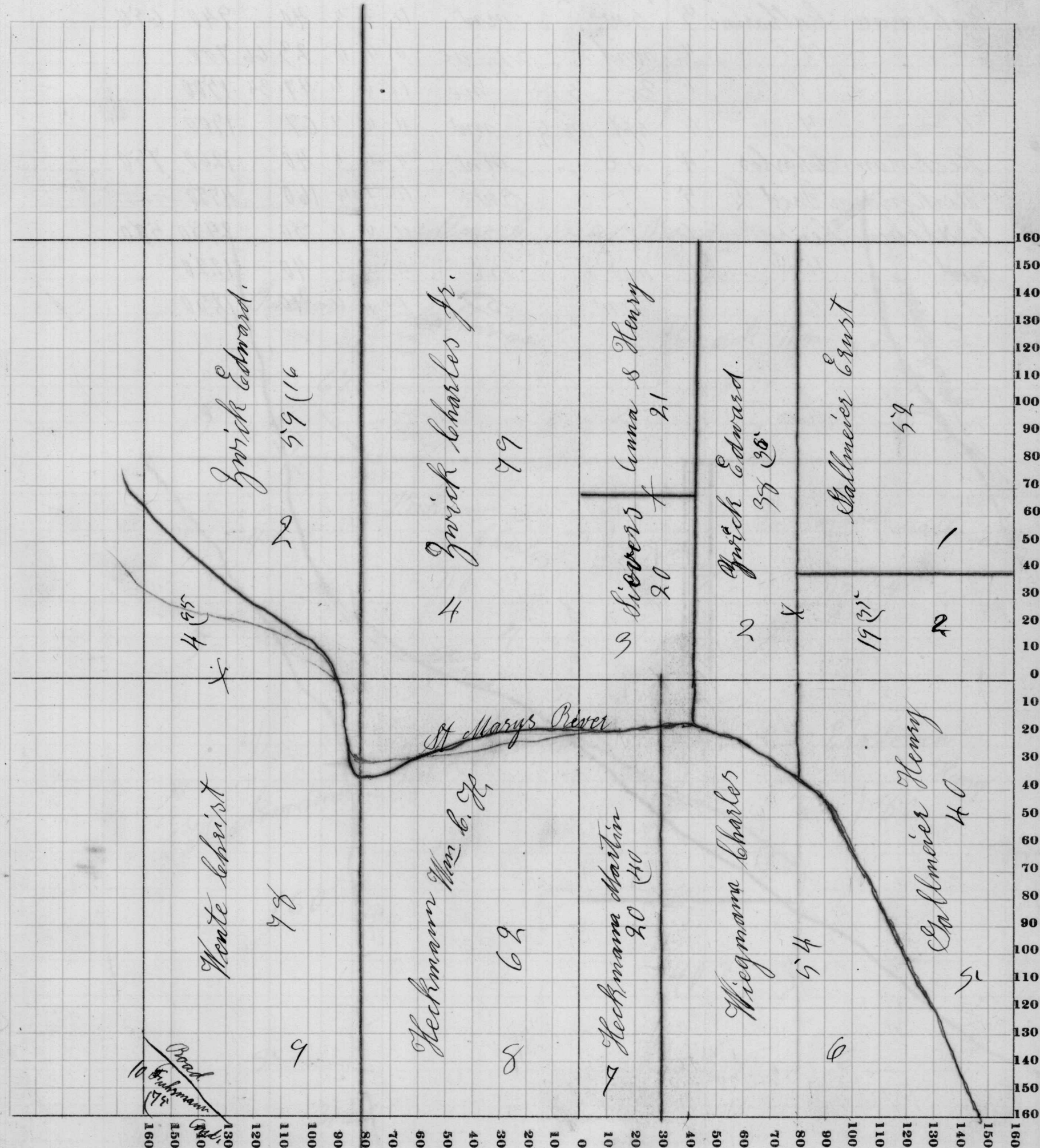

NAMES OF OWNERS	Number on Plat	DESCRIPTION	Section	Township	Range	Acres	Hundredths	Value of Lands	Value of Improvements	Value of Lands and Improvements
-----------------	----------------	-------------	---------	----------	-------	-------	------------	----------------	-----------------------	---------------------------------

Zwick Edward	1	ne pt ne	9	28	13	20		640		
Bauch Wan.	2	pt n 1/2 ne	"	"	"	40	25	1140		
Fuhrmann Catharine	3	sw nw	"	"	"	40		940	650	
" "	"	wnd 1/2 s 1/2 ne	"	"	"	23	66	700		
" "	"	1/2 s 1/2 ne	"	"	"	47	34	1500		
" "	"	spt n 1/2 sw	"	"	"	67		1900		
Heckmann Charles	4	se nw	"	"	"	40		1260	750	
Heckmann Fred Jr.	5	sw	"	"	"	160		4750		
Erxleben Henry	6	e 1/2 se	"	"	"	80		2480	580	
" "	"	nw se	"	"	"	40		1220		
" "	"	sw se	"	"	"	40		1280		

SCALE: Forty rods to an inch, or ten rods to a space, Congress Land, which is one mile square for a section.

Number of acres in this section, according to the United States Survey,.....

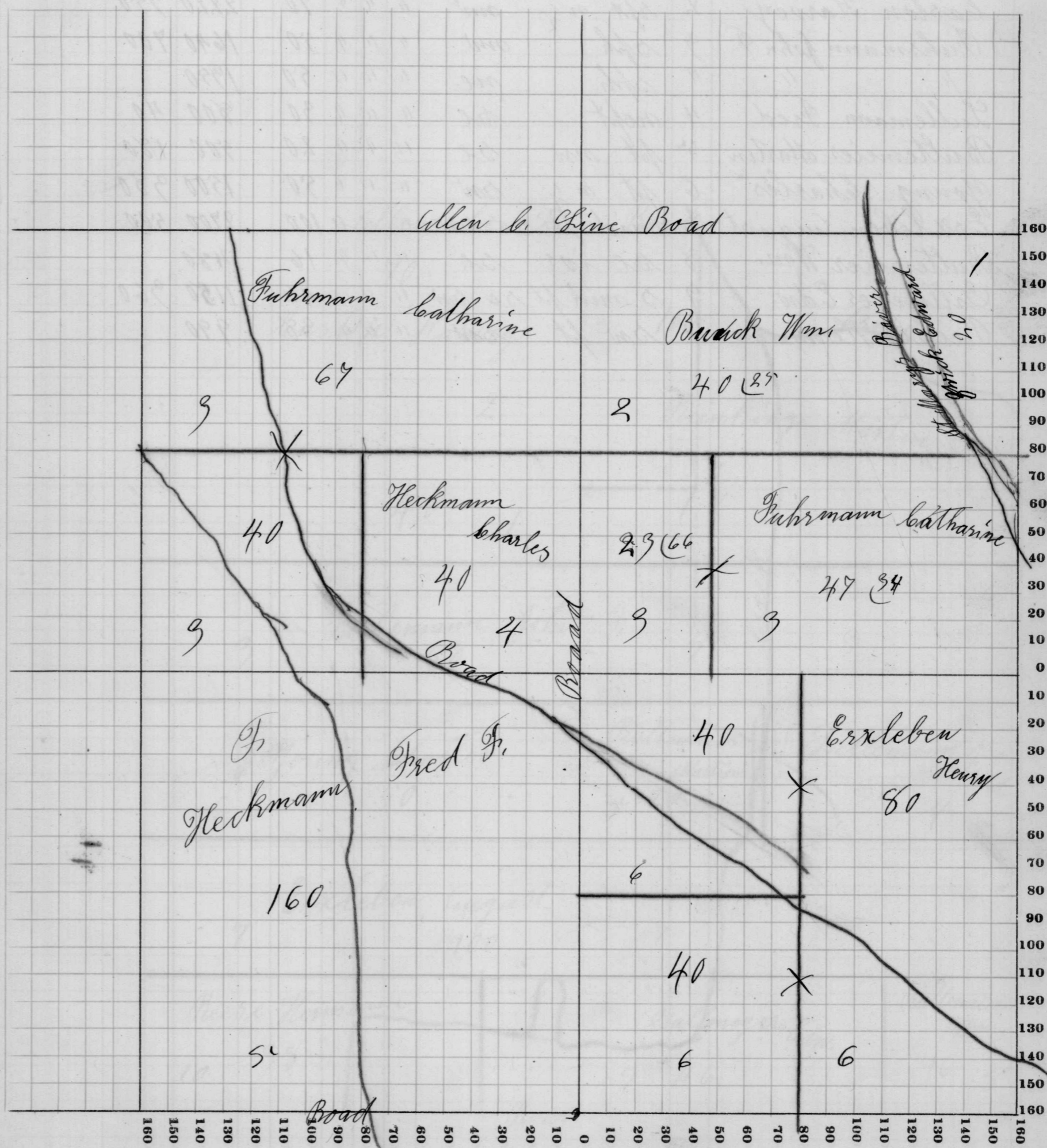

Assessor's Plat-Book for

Proble

Township, No.

Congressional Township No. 28, R. 13

NAMES OF OWNERS	Number on Plat	DESCRIPTION	Section	Township	Range	Acres	Hundredths	Value of Lands	Value of Improvements	Value of Lands and Improvements
Reinking Martin	1	nw ne	4	28	13	110		2990		
" "	"	n 1/2 s 1/2 nw	1	"	"	40		1280	750	
Easton Harvey	2	rpt n 1/2 nw	"	"	"	70		2220	350	
Fuhrmann John F.	3	sph nw	"	"	"	50		1640	700	
" "	"	sph ne	"	"	"	50		1950		
Lulleman Fred	4	nept se	"	"	"	30		800	40	
Bullemier Martin	5	pt nw se	"	"	"	20		500	180	
Young Charles	6	pt n 1/2 sw	"	"	"	50		1500	380	
Erxleben August	7	mid pt se sw	"	"	"	100		2200	500	
Bullemier Wm.	8	se cor se	"	"	"	16		480		
Gallmeyer Edw.	9	s mid pt se sw	"	"	"	46		1150	360	
Beese Hermann	10	sw pt sw	"	"	"	38		990		

SCALE: Forty rods to an inch, or ten rods to a space, Congress Land, which is one mile square for a section.
 Number of acres in this section, according to the United States Survey,

