

	Zwick Funeral Home Records 1918-1922
Name of Deceased	Mrs. Emma E. Mann
Removing Remains	From train to Coat Kirk's (?) res; \$5.00
Embalming	
Shaving & Laying Out	
Casket No.	
Outside Case	
Handles	
Lining & Pillow Set	
Metal Vault	
Mountings	
Burial Robe	
Slippers	
Candelabra	
Door Dressing	
Flowers	
Funeral Notices	
Hearse	
Transportation Expenses	
Telephone	
Clergyman	
Vault Charges	
Opening Grave	
Date of Funeral	May 13, 1920; 10:30 a.m.
Date of Death	May 09, 1920
Place of Death	Liberal, Seward Co., Kansas
Place of Funeral	ME Church, Decatur, Ind.
Clergyman	Chas. Tinkham
Date of Burial	May 13, 1920
Where Interred	Decatur Cemetery
Date of Birth	
Age	64 years
Color	White
Occupation	Housewife
Status	Married
Birthplace	
Last Place of Residence	Liberal, Kansas
How Long Resident of This State	
Husband's/Wife's Name	J. R. Mann
Father's Name	
Country of Birth	
Mother's Name	
Country of Birth	
Physician	E. F. Pellitte, Liberal, Kansas
Cause of Death	Cancer
Ordered By	J. R. Mann
Charge To	J. R. Mann
When Rendered	May 12 & 13
Received on Account	May 13, 1920; by cash \$15.00
	May 14, 1920; by cash \$5.00 (Paid \$20.00)

Funeral of Mrs Emma E Mann Hour 10:30 May 13 1920 9 A.M.

Removing Remains from Danville Co. Ark. to Liberal
Embalming
Shaving and Laying Out
Casket No. 542 Size
Metal Inner Casket Copper Zinc
Handles No.
Outside Case, Pine, Chestnut, Oak, Mahogany
Lining and Pillow Set No.
Metal Lined Box
Mountings Handles Plate
Metal Vault, Style
Box Mattress
Burial Robe
Slippers Prs Gloves
Doz. Chairs
Personal Attendance and Assistants
Drapery Candelabra Candles
Pedestals Rug

CASH EXPENDITURES

Door Dressing
Palms
Flowers
Porters and Gloves
General Notices
Man
Organist
Lining
Charges
Service
For Paradox 10.00
5.00
Telephone
ation Expenses

Date of Death May 9 1920
Place of Death Liberal Edward Co Kansas
Place of Funeral W.E. Church Decatur Ind
Clergyman Leis Vinham
Date of Burial May 13 1920
Where Interred Decatur Cemetery
Grave or Lot No. Section
Location of Grave

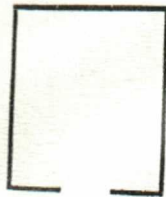

Age 64 Years Months Days
Color White Occupation House Wf
Single, Married, Widow, Widower Widow
Birthplace
Last place of residence Liberal Kansas
How long resident of this State
Husband's Name J. R. Mann
Father's Name
Country of Birth
Mother's Name
Country of Birth
Physician E. F. Pallette Liberal Kan
Cause of Death Cancer

Ordered by J. R. Mann
Charge to
When rendered May 12 & 13

RECEIVED ON ACCOUNT

Date	Description	Amount
May 13	Pay cash	45.00
14	" "	5.00
		20.00
		10.00
		5.00

(Handwritten signature and notes over the table)