

	Jahn Funeral Home 1922 Record
Name of Deceased	Clara Leona Fuhrman
Page Number	No. 276
Date of Funeral	March 12, 1922
Removing Remains	
Embalming	
Shaving & Laying Out	
Casket Number	4219 Constantine; Int 4293
Size	3' 6"; \$55.00
Metal Inner Casket	
Copper	
Zinc	
Handles No.	ORV
Outside Case	
Lining & Pillow Set No.	
Metal Lined Box	
Mountings	
Metal Vault, Style	Boyd; 3' 6"; \$65.00
Box Mattress	
Burial Robe	
Slippers/Gloves	Slippers \$1.50
Doz. Chairs	
Pers. Attendants & Assistants	
Drapery/Candles	
Pedestals/Rug	
Door Dressing	
Flowers/Palms	Spray; \$7.00
Funeral Notices	
Clergymen/Sexton	
Quartette/Soloist/Organist	
Delivering Box To	
Opening Grave	
Vault Charges	
Hearse	
Coaches	
Telegrams/Telephone	
Transportation Expenses	
Date of Death	March 09, 1922
Place of Death	Lutheran Hospital, Fort Wayne, Indiana
Place of Funeral	Fredhime Lutheran Church
Clergyman	Rev. Pruess
Date of Burial	March 12, 1922
Where Interred	Fredhime Lutheran Cemetery
Grave/Lot No./ Section	
Location of Grave	
Date of Birth	April 19, 1920
Age	1 Year, 10 Months, 10 Days
Color	White
Occupation	
Marital Status	Single
Birthplace	
Last Place of Residence	
How Long in This State	Life

Husband/Wife Name	
Father's Name	Martin E. Fuhrman
Country of Birth	Preble Tp., Adams Co., Indiana
Mother's Name	Clara Young
Country of Birth	Wells Co., Indiana
Physician	James A. Lomas, Ft. Wayne
Cause of Death	General Peritonitis
Ordered By	Martin E. Fuhrman
Charge To	Martin E. Fuhrman
When Rendered	March 12, 1922
Received on Account	Jan. 15, 1923; by ck; \$100.00
	Oct. 31, 1923; by ck; \$10.00
	Sept. 30, 1924; by cash; \$20.35 (Paid \$130.35)

Funeral of Clara Lena Fubman
Date of Funeral Feb. 12 1922 Hour _____ M.

Removing Remains.....
Embalming..... RT
Shaving and Laying Out.....
Casket No. H&I Contamin 4293 Size 24 29 15 5.50
Metal Inner Casket..... Copper..... Zinc.....
Handles No..... ORV
Outside Case, Pine, Chestnut, Oak, Mahogany.....
Lining and Pillow Set No.....
Metal Lined Box.....
Mountings..... Handles..... Plate.....
Metal Vault, Style Box 2-8..... R7SD 65.00
Box Mattress.....
Burial Robe.....
Slippers X..... Prs..... Gloves 7ST 1.50
..... Doz. Chairs.....
Personal Attendance and Assistants.....
Drapery..... Candelabra..... Candles.....
Pedestals..... Rug.....

CASH EXPENDITURES.

Door Dressing.....
..... Palms.....
Flowers Gray..... 5.05 7.00
.....
..... Porters and..... Gloves.....
Funeral Notices.....
.....
.....

Date of Death Feb. 9 1922
Place of Death Fullin Hospital 27 W. 2nd
Place of Funeral Fubman Lutheran Church
Clergyman Rev. P. Ross
Date of Burial Feb. 12 1922
Where Interred Fubman Lutheran cemetery
Grave or Lot No..... Section.....
Location of Grave.....

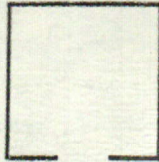

Date of Birth April 19 1920
Age..... 1..... Years..... 10..... Months..... 10..... Days.....
Color White..... Occupation.....
Single, Married, Widow, Widower.....
Birthplace.....
Last place of residence.....
How long resident of this State..... Life
Husband's Name.....
Father's Name Martin E. Fubman
Country of Birth Public T.P. Adams Co Ind.
Mother's Name Clara Young
Country of Birth..... Ind. Ind.
Physician James A. Thomas M.D. 24
Cause of Death General Peritonitis

Ordered by Martin E. Fubman
Charge to.....
When rendered Feb. 12 1922

RECEIVED ON ACCOUNT.

1923			
Jan	15	By check	100
Feb	31	"	10 00
Feb	30	" cash	20 35
			130 35

Paid

Clergyman.....
Sexton.....
Quartette, Soloist..... Organist.....
Delivering Box to.....
Opening Grave..... Lining.....
Vault Charges.....
Hearse.....
Coaches.....
Telegrams..... Telephone.....
Transportation Expenses.....

1.85