

| | |
|--------------------------|--------------------------------------|
| | Hardy & Hardy Funeral Home Record |
| | |
| Date of Entry | October 26, 1946 |
| Race | White |
| Name of Deceased | Job L. Yaney |
| Page Number | |
| Marital Status | Widowed |
| Residence | |
| Charge To | Estate |
| Address | |
| Order Given By | Chester Smitley |
| Spouse | |
| How Secured | Phoned |
| If Veteran, State War | |
| Occupation | Farmer - retired |
| Social Security No. | |
| Employer and Address | |
| Date of Death | October 26, 1946 |
| Date of Birth | August 1, 1864 |
| Age | 82 years |
| Date of Funeral | October 29, 1946; Tuesday; 2:00 p.m. |
| Services At | Bethel Brethren Church |
| Clergyman | Rev. G. L. Lawler - Berne |
| Religion of the Deceased | Brethren |
| Birthplace | Mercer Co., Ohio |
| Resided in the State | |
| Place of Death | Milton, Wisconsin |
| Cause of Death | Heart Trouble |
| Contributory Cause | Coronary Thrombosis |
| Certifying Physician | Dr. Davis |
| His Address | Milton, Wisconsin |
| Name of Father | David Yaney |
| His Birthplace | Germany |
| Maiden Name of Mother | Julia Burl |
| Her Birthplace | Jay Co. |
| Motor/Ship Remains To | |
| Size of Casket | Noll; Metal-Gunmetal |
| Manufactured By | Cincinnati Coffin |
| Cemetery | MRE |
| Lot No. | |
| Grave No. | |
| Section No. | |
| Block No. | |
| Owner | |

① Date of Entry... *October 26, 1946* 1946
White
(What Race)

Husband Wife Widow
of of } Age of Husband or Wife (if living) Years

Total No.

Name of Deceased... *Job L. Yancy*
 Married Single Widowed Divorced

Residence.....

Charge to... *Estate*

Address.....

Order given by... *Chester Smitley*
(or informant)

How Secured... *Phoned*

If Veteran, State War.....

Occupation... *Farmer - Retired*
(Social Security Number)

Employer and Address.....

Date of Death... *October 26, 1946*
(Date) (Hour)

Date of Birth... *August 1, 1864*
(Date) (Month) (Day) (Year)

Age... *82*
(Years) (Month) (Days)

Date of Funeral... *10/29/46 Tuesday 2:00 P.M.*
(Date) (Day of Week) (Time)

Services at... *Beulah Brethren Church*

Clergyman... *Rev. G. L. Lawler - Beulah*
(Address)

Religion of the Deceased... *Brethren*

Birthplace... *Mercer Co. Ohio*

Resided in the State...
(or U. S. or City or County) (Years) (Month)

Place of Death... *Milton Wisconsin*

Cause of Death... *Heart trouble*

Contributory Causes... *Coronary Thrombosis*

Certifying Physician... *Dr. Davis*
(or Coroner)

His Address... *Milton, Wis.*

Name of Father... *Samuel Yancy*

His Birthplace... *Germany*

Maiden Name of Mother... *Julia Beard*

Her Birthplace... *Ind. Co.*

Motor Ship } Remains to

Size of Casket... *Noel - Metal - Green*
(State Color and Number)

Manufactured by... *Commercial Coffin*

Cemetery } *M. R. E.*
Crematory }

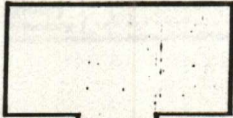

Diagram of Lot or Vault

Lot No.....

Grave No.....

Section No.....

Block No.....

OWNER.....