

	Hardy & Hardy Funeral Home Record
Name of Deceased	Mina Whiteman
Page Number	Page 215
Marital Status	Widowed
Residence	Geneva, Ind.
Charge To	
Address	
Order Given By	
Spouse	
If Veteran, State War	
Occupation	Housewife
Social Security No.	
Employer and Address	
Date of Death	March 1, 1953; 11:30 a.m.
Date of Birth	May 9, 1871
Age	81 years
Date of Funeral	March 4, 1953; Wednesday; 2:30 p.m.
Services At	Hardy Funeral Home
Clergyman	
Religion of the Deceased	
Birthplace	Jay Co., Indiana
Resided in the State	
Place of Death	Clarence Potter Res. - Garr??
Cause of Death	Coronary Occlusion
Contributory Cause	
Certifying Physician	R. A. Nason - H. I.
His Address	Garret, Ind.
Name of Father	Balser Gierhart
His Birthplace	
Maiden Name of Mother	Amelia Kraner
Her Birthplace	
Motor/Ship Remains To	
Size of Casket	Manuseal - Gray Int.
Manufactured By	Batesville Casket Co.
Cemetery	Riverside
Lot No.	
Grave No.	
Section No.	
Block No.	
Owner	

No. 215 Yearly No.

Name of Deceased *Mrs. Whitman*

Single  Widowed  Divorced

Residence *London Ind.*

City

Order given by (or informant)

How served

Illness, State Fair

Occupation *Housewife* (Social Security Number)

Employer and Address

Date of Death *March 1, 1953* 11:30 *A* (Hour)

Date of Birth *May 9, 1871*

Age *81*

Date of Burial *3/4/53* *Wed* 2:30 *P* (Day of Week) (Hour)

Interment *Fun. Home*

City (Address)

Religion of the Deceased

Burial *John G. Johnson*

Buried in the State

Place of Burial *Fun. Home, No. 1000* (City & Country) (Years) (Months)

Case of Death *Cerebral Occlusion*

Contributory Causes

Ordering Physician *R.A. Nasson - M.D.*

His Address *London, Ind.* (or City)

Name of Father *Charles E. Whitman*

His Birthplace

Maternal Name of Mother *Amelia Kiser*

Her Birthplace

Year of Emigration *1860*

State of Issuance *Indiana* (State Color and Number)

Manufactured by *Batesville Lumber Co.*

County *Warrick*

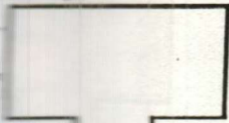

Lot No. ....  
Grave No. ....  
Section No. ....  
Block No. ....  
Owner .....