

	Hardy & Hardy Funeral Home Record
Name of Deceased	Edward Hagerty
Page Number	Page 5
Marital Status	Married
Residence	Geneva, Indiana
Charge To	Estella Hagerty
Address	Geneva, Indiana
Order Given By	Wife
Spouse	
How Secured	
If Veteran, State War	
Occupation	Carpenter
Social Security No.	260-12-1363
Employer and Address	
Date of Death	November 27, 1946; 5:30 p.m.
Date of Birth	May 15, 1874
Age	72 years
Date of Funeral	November 30, 1946; Saturday; 2:00 p.m.
Services At	Hardy Funeral Home
Clergyman	Rev. James Richardson
Religion of the Deceased	
Birthplace	Ohio
Resided in the State	
Place of Death	Adams County Hospital
Cause of Death	
Contributory Cause	
Certifying Physician	Dr. D. D. Jones
His Address	Berne, Indiana
Name of Father	
His Birthplace	
Maiden Name of Mother	
Her Birthplace	
Motor/Ship Remains To	
Size of Casket	Metal-grey
Manufactured By	
Cemetery	
Lot No.	
Grave No.	
Section No.	
Block No.	
Owner	

FUNERAL

Date of Entry December 4 1946

White
(What Race)

Husband Wife Widow
Age of Husband or Wife (if living) _____ Years

Total No. 5 Yearly No. _____

Name of Deceased Edward Wagerty
 Married Single Widowed Divorced
 Husband Wife W

Residence Geneva, Indiana

Charge to: Estelle Wagerty

Address: Geneva, Indiana

Order given by: Wife
(or informant)

How Secured _____

If Veteran, State War _____

Occupation: Carpenter 260-12-1363
(Social Security Number)

Employer and Address _____

Date of Death: November 27, 1946 5:30 P.M.
(Date) (Hour)

Date of Birth: May 13, 1874

Age: 72
(Years) (Months) (Days)

Date of Funeral: Nov. 28th, Saturday, 2:00 P.M.
(Date) (Hour) (Minute)

Services at: Home

Clergyman: Rev. James R. Schuler
(Address)

Religion of the Deceased _____

Birthplace: Ohio

Resided in the State _____
(or U. S. or City or Country) (Years) (Months)

Place of Death: Geneva Co. Hospital

Cause of Death _____

Contributory Causes _____

Certifying Physician: Dr. D. D. Jones

His Address: Geneva, Indiana

Name of Father _____

His Birthplace _____

Maiden Name of Mother _____

Her Birthplace _____

Motor } Remains to _____
Ship }

Size of Casket: Metal - green
(Single Color and Number)

Manufactured by: _____

Cemetery } _____
Crematory }

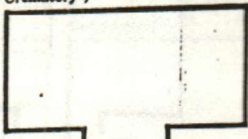

Lot No. _____
Grave No. _____
Section No. _____
Block No. _____
Owner _____