

	Hardy & Hardy Funeral Home Record
Name of Deceased	Gee R. Greene
Page Number	Page 190
Marital Status	Married
Residence	Geneva, Indiana
Charge To	
Address	
How Secured	
If Veteran, State War	
Occupation	Oil Worker
Social Security No.	
Employer and Address	
Date of Death	April 2, 1952; 2:30 p.m.
Date of Birth	June 21 (or 27), 1886
Age	66 Years
Date of Funeral	April 5, 1952; Saturday; 2:00 p.m.
Services At	Hardy Funeral Home
Clergyman	
Religion of the Deceased	
Birthplace	Carroll, Ohio
Resided in the State	
Place of Death	Adams Co. Hosp.
Cause of Death	Surgical Shock
Contributory Cause	Carcinoma ?? Colon; Bowel Obstruction
Certifying Physician	Dr. C. P. Hinchman
His Address	Geneva, Indiana
Name of Father	Joseph Greene
His Birthplace	
Maiden Name of Mother	Martha Fellers
Her Birthplace	
Motor/Ship Remains To	
Size of Casket	Cloth
Manufactured By	Mid West Casket Co.
Cemetery	Westlawn
Lot No.	
Grave No.	
Section No.	
Block No.	
Owner	No. 66000

Form No. 190 Yearly No. 9
Name of Deceased Lee R. Greene
 Married Single Widowed Divorced

Residence: Geneva, Ind.
Charge to:
Address:
Order given by: (or informant)

Is Veteran, State War
Occupation Oil Worker
Employer and Address

Date of Death April 2, 1952 2:30 P.M.
Date of Birth June 21, 1886
Age 66 (Years) (Months) (Days) 7

Date of Funeral 4-5-1952 Sat. 2:00 P.M.
Services at Hardy Funeral Home
Clergyman (Address)

Religion of the Deceased
Birthplace Cassell, Ohio
Resided in the State (or U.S. or City or County) (Years) (Months)

Place of Death Adams Co. Hosp.
Cause of Death Surgical Shock
Contributory Cause Carcinoma descending

Colon Bowel Obstruction
Certifying Physician Dr. C. P. Finckema
His Address Geneva, Ind. (or Coroner)
Name of Father Joseph Greene

His Birthplace
Maiden Name of Mother Martha Teller
Her Birthplace

Motor } Remains to
Ship }
Size of Casket Cloth (Style, Color and Number)
Manufactured by Mt. West Casket Co.

Cemetery } West Lawn
Crematory }
Lot No.
Grave No.
Section No.
Block No.

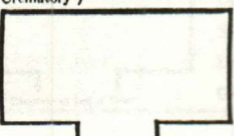

Diagram of Lot or Vault

Owner L.L.O.O.O.