

	Hardy & Hardy Funeral Home Record
Name of Deceased	Clara Bell Cookerly
Date of Entry	Dec. 14, 1954
Page Number	Page 267
Marital Status	Widowed
Residence	R. R. 2, Bryant
Charge To	
Address	
Order Given By	
Spouse	Lemuel
If Veteran, State War	
Occupation	
Social Security No.	
Employer and Address	
Date of Death	Cut off
Date of Birth	Cut off
Age	Cut off
Date of Funeral	Dec. 16, 1954; Friday; 2:00 p.m.
Services At	Hardy Funeral Home
Clergyman	Rev. Roy Lewis; R1 Albany
Religion of the Deceased	Quaker??
Birthplace	Jay County
Resided in the State	
Place of Death	Portland Nursing Home
Cause of Death	Uremia
Contributory Cause	Generalized arteriosclerosis
Certifying Physician	Dr. Jas. V. Schetgen
His Address	Geneva, Indiana
Name of Father	George Hardin
His Birthplace	
Maiden Name of Mother	Mary Ellen Time
Her Birthplace	
Motor/Ship Remains To	
Size of Casket	
Manufactured By	Indpls. Casket Co.
Cemetery	Gravel Hill
Lot No.	
Grave No.	
Section No.	
Block No.	
Owner	

# RECORD OF FUNERAL

Record No. 267 Yearly No. \_\_\_\_\_ Date of Entry Dec 12 1954

Name of Deceased Charles Lee Gasterly (White)  
 Married  Single  Widowed  Divorced

Residence R.R. 2 Boyant Chapel Hill

Charge to: \_\_\_\_\_

Address: \_\_\_\_\_

Order given by: \_\_\_\_\_ (or informant)

How Secured: \_\_\_\_\_

Date of Funeral 12/16/54 Fri 2:00 P.M.  
(Date) (Day of Week) (Hour)

Services at Hardy Funeral Home

Clergyman: Rev. Roy Lewis Albany

Religion of the Deceased Quaker

Birthplace Indy, C.

Resided in the State \_\_\_\_\_ (or U.S. or City and County) (Years) (Months)

Place of Death Charlotte, N.C.

Cause of Death Uremia

Contributory Causes Generalized arteriosclerosis

Certifying Physician Dr. J. Schutzen

His Address Revere, Ind.

Name of Father Geo. Hardin

His Birthplace \_\_\_\_\_

Maiden Name of Mother Mary Elm Stone

Her Birthplace \_\_\_\_\_

Motor Vehicle } Remains to \_\_\_\_\_  
 Ship } \_\_\_\_\_

Size of Casket \_\_\_\_\_

Manufactured by Anderson & Co. (State and Number)  
 Cemetery } Gravel Hill

Lot No. \_\_\_\_\_

Grave No. \_\_\_\_\_

Section No. \_\_\_\_\_

Block No. \_\_\_\_\_

Owner \_\_\_\_\_

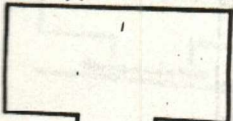

519 Diagram of Lot or Vault

Record No. 268 Yearly No. \_\_\_\_\_

Name of Deceased Henry Lee Cover

How Secured: \_\_\_\_\_

Occupation \_\_\_\_\_

Employer and Address \_\_\_\_\_

Date of Death Dec 3, 1954

Date of Birth Oct 27, 1883

Age \_\_\_\_\_

Date of Funeral \_\_\_\_\_

Services at Hardy Funeral Home

Clergyman Rev. B. W. Paul

Religion of the Deceased U.P.

Birthplace Revere, Ind.

Resided in the State \_\_\_\_\_

Place of Death Indy, Ind.

Cause of Death Chloroform

Contributory Causes Whooping Cough

Certifying Physician Dr. J. Schutzen

His Address Revere, Ind.

Name of Father Robert E. Cover

His Birthplace Revere, Ind.

Maiden Name of Mother Esther Pauline

Her Birthplace \_\_\_\_\_

Motor Vehicle } Remains to \_\_\_\_\_  
 Ship } \_\_\_\_\_

Size of Casket 36"

Manufactured by \_\_\_\_\_

Cemetery } Gravel Hill