

RECORD OF FUNERAL.

No. 32 Date 8/22 1911

Name of Deceased Carrie Craig

Charge to J W Craig

Order Given by " " "

How Secured _____

Date of Funeral 8/25

Place of Death Berne

Funeral Services at Residence

Time of Funeral Service 2 P.M.

Clergyman Kottman

Certifying Physician Reerer

His Residence Berne

Number of Burial Certificate _____

Cause of Death _____

Date of Death 8/22

Occupation of the Deceased _____

Single or Married _____ Religion _____

Aged 34 Years, 11 Months, 2 Days.

Body to be shipped to _____

Size and Style of Casket or Coffin 6 ft - 1 1/2"

Silk Plush

Manufactured by Aora Casket Co

Metallic Lining _____

Outside Box _____

Number of Handles opensive

Interment at M R E Cemetery

Lot or Grave No. _____ Section No. _____

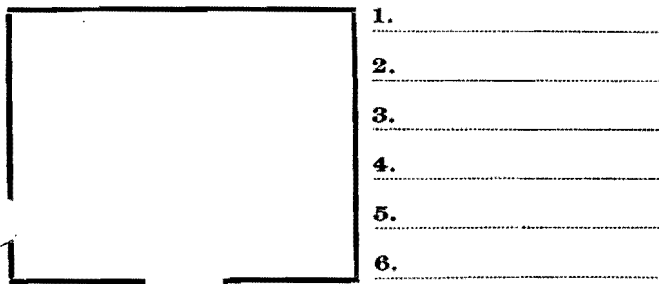

(Diagram of Lot.)

Designate all Graves in Lot with Numbers (1, 2, 3, 4, etc.), as mark space for this Funeral with a cross (X).

Designate place for Monument with a small square (■).

At the bottom of Diagram for the names of those buri

B 9/20/1874, OH
 sp John W. Craig
 f. Henry Clay Eppley, OH
 m — Crabill, OH
 d. pneumonia
 Cont. Brights disease
 Berne 13 p80-81